

TREE LEGEND:

BE	BEECH
CED	CEDAR
CH	CHERRY
CHN	CHESTNUT
HIC	HICKORY
JMP	JAPANESE MAPLE
LIN	LINDEN
LOC	LOCUST
MP	MAPLE
O	OAK
P	PINE
SP	SPRUCE
SYC	SYCAMORE

LEGEND ABBREVIATIONS:

AC	AIR CONDITIONER
BIT. CONC.	BITUMINOUS CONCRETE
BOL.	BOLLARD
CB	CATCH BASIN
C.J.L.	COASTAL JURISDICTION LINE
CL&P	CONNECTICUT LIGHT AND POWER
EL	ELEVATION
ELEC. TRANS.	ELECTRIC TRANSFORMER
EMH	ELECTRIC MANHOLE
FW	FIRE HYDRANT
FP	FLAG POLE
GAR. FL.	GARAGE FLOOR
GEN.	GENERATOR
GMH	GREASE MANHOLE
GT	GREASE TRAP
HC	HANDICAP
HDPE	HIGH-DENSITY POLYETHYLENE PIPE
HTL	HIGH TIDE LINE
INV	INVERT
LP	LIGHT POLE
MC	METAL COVER
MHW	MEAN HIGH WATER
NAVD	NORTH AMERICAN VERTICAL DATUM
PT	PROPANE TANK
PVC	POLY VINYL CHLORIDE PIPE
RR. TIE	RAILROAD TIE
SNET	SOUTHERN NEW ENGLAND TELEPHONE
SSMH	SANITARY SEWER MANHOLE
TYP	TYPICAL
WV	WATER VALVE

LEGEND

SYMBOLS	DESCRIPTION
⊙ SSMH	SEWER MANHOLE
⊠ CB	CATCH BASIN
⊕ UP#	UTILITY POLE
⊙ LP	LIGHT POLE
⊕ FW	FIRE HYDRANT
⊙ WV	WATER VALVE
---	PROPERTY LINE
---	20' CONTOUR
X 20.1	SPOT ELEVATION
△ WF#1	WETLAND FLAG

INN AT LONGSHORE ELEVATIONS

TOP OF BOTTOM FLOOR (INCLUDING BASEMENT, CRAWLSPACE, OR ENCLOSURE FLOOR)	13.20
TOP OF NEXT HIGHER FLOOR	21.70
LOWEST ELEV. OF MACHINERY AND EQUIPMENT SERVICING THE BUILDING	13.20
LOWEST ADJACENT GRADE NEXT TO BUILDING	13.40
HIGHEST ADJACENT GRADE NEXT TO BUILDING	18.50
FINISHED LOWEST ADJACENT GRADE AT LOWEST ELEV. OF ATTACHED DECK OR STAIRS	16.30
SECOND FLOOR ELEVATION	32.3
THIRD FLOOR ELEVATION	42.3
ROOF AREA	
BALLROOM FLAT ROOF	750± S.F.
BALLROOM PITCHED ROOF	4,030± S.F.
RESTAURANT ROOF	700± S.F.

- SURVEY NOTES:**
- THIS SURVEY AND MAP HAS BEEN PREPARED IN ACCORDANCE WITH THE REGULATIONS OF CONNECTICUT STATE AGENCIES, SECTIONS 20-300b-1 THROUGH 20-300b-20, AND THE "MINIMUM STANDARDS FOR SURVEYS AND MAPS IN THE STATE OF CONNECTICUT" AS ADOPTED BY THE CONNECTICUT ASSOCIATION OF LAND SURVEYORS, INC., ON OCTOBER 26, 2018.
 - THIS SURVEY IS A ZONING LOCATION & TOPOGRAPHIC SURVEY WITH THE BOUNDARY DETERMINATION CATEGORY OF WHICH IS A RESURVEY CONFORMING TO HORIZONTAL ACCURACY CLASS "A-2" AND VERTICAL ACCURACY CLASS "T-2" AND IS INTENDED TO DEPICT OR NOTE THE POSITION OF EXISTING OR PROPOSED IMPROVEMENT WITH RESPECT TO APPLICABLE MUNICIPAL SETBACK REQUIREMENTS IN ORDER TO ENABLE DETERMINATION OF COMPLIANCE WITH SAID REGULATIONS.
 - THIS SURVEY WAS PREPARED FOR A SPECIFIC PURPOSE. ANY USE OTHER THAN FOR THAT WHICH WAS INTENDED IS A MISUSE OF THIS INFORMATION AND RENDERS THE PREPARERS' DECLARATION NULL AND VOID.
 - UNDERGROUND IMPROVEMENTS OR ENCROACHMENTS IF ANY ARE NOT SHOWN.
 - UNAUTHORIZED ALTERATIONS OR ADDITIONS TO THIS SURVEY, WHICH BEARS THE SURVEYORS STAMP OF SEAL, RENDERS ANY DECLARATION SHOWN HEREON NULL AND VOID.
 - THIS DECLARATION SHOWN RUNS TO THE PERSON, OR PERSONS FOR WHOM THE SURVEY WAS PREPARED FOR THIS DECLARATION IS NOT TRANSFERABLE.
 - VERTICAL DATUM: NAVD 88
 - TIDAL WETLANDS AS FLAGGED BY THOMAS RYDER ECOLOGIST AT LANDTECH, OCTOBER 19 & 23, 2023.
 - PARTIAL SUBJECT PROPERTY IS LOCATED IN FEMA FLOOD HAZARD ZONE "AE" (EL.13), "AE" (EL.14), "VE" (EL.14) AND "VE" (EL.15) AND ZONE "X" AS SHOWN ON FEMA FIRM PANEL No. 09001C 0551G, EFFECTIVE JULY 8, 2013.
 - THE SUBJECT PROPERTY IS LOCATED WITHIN A FEMA DESIGNATED SPECIAL FLOOD HAZARD AREA COASTAL A ZONE AS SHOWN ON MAP/PANEL 09001C 0551G, EFFECTIVE JULY 8, 2013. THE LIMIT OF MODERATE WAVE ACTION (LMA) LINE SHOWN INDICATES THE INLAND LIMIT OF THE COASTAL A ZONE.

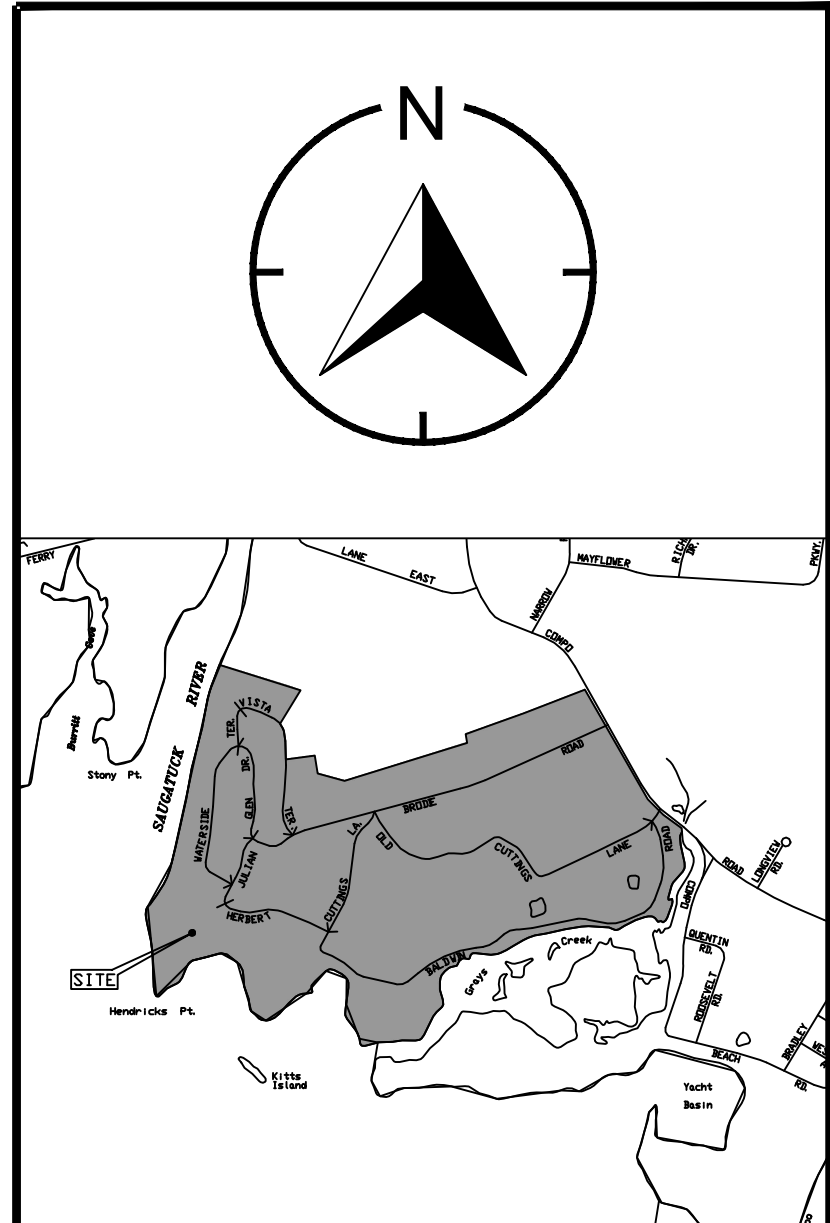

LOCATION MAP
SCALE: 1" = 1500'

PROPERTY INFORMATION:

OWNER: TOWN OF WESTPORT
 LONGSHORE
 ADDRESS: 260 COMPO ROAD SOUTH
 WESTPORT, CT

ZONE: RESIDENCE "AAA"
 DEED: BK. 172 PG. 585

MAP: C04
 LOT: 001

REVISION DATE: _____ ISSUE: _____

LANDTECH
 SITE/CIVIL • ENVIRONMENTAL • SURVEYING • PLANNING
 518 RIVERSIDE AVENUE • WESTPORT, CT 06880 • 203-454-2110
 HELLO@LANDTECHCONSULT.COM • WWW.LANDTECHCONSULT.COM

PREPARED FOR:

INN AT LONGSHORE

PROJECT LOCATION:
**260 COMPO ROAD SOUTH
 WESTPORT, CT**

DRAWING TITLE:
PARTIAL TOPOGRAPHIC SURVEY

PROJECT NO. **21240-01**

DATE: 10/31/2023 DRAWN BY: L.A.M. CHECKED BY: T.A.D.

SCALE: 1" = 40'

IN FEET
 0 40 80 120

TO MY KNOWLEDGE AND BELIEF THIS MAP IS SUBSTANTIALLY CORRECT AS NOTED HEREON

Thomas A. Deilus

THOMAS A. DEILUS, LAND SURVEYOR
 CT. REGISTRATION NO. 70098

THE SURVEY AND DECLARATION SHOWN HEREON IS NULL AND VOID WITHOUT THE LICENSED SURVEYORS LIVE SIGNATURE AND SEAL.

STATE OF CONNECTICUT
 THOMAS A. DEILUS
 No. 70098
 LICENSED LAND SURVEYOR

SV-1.1

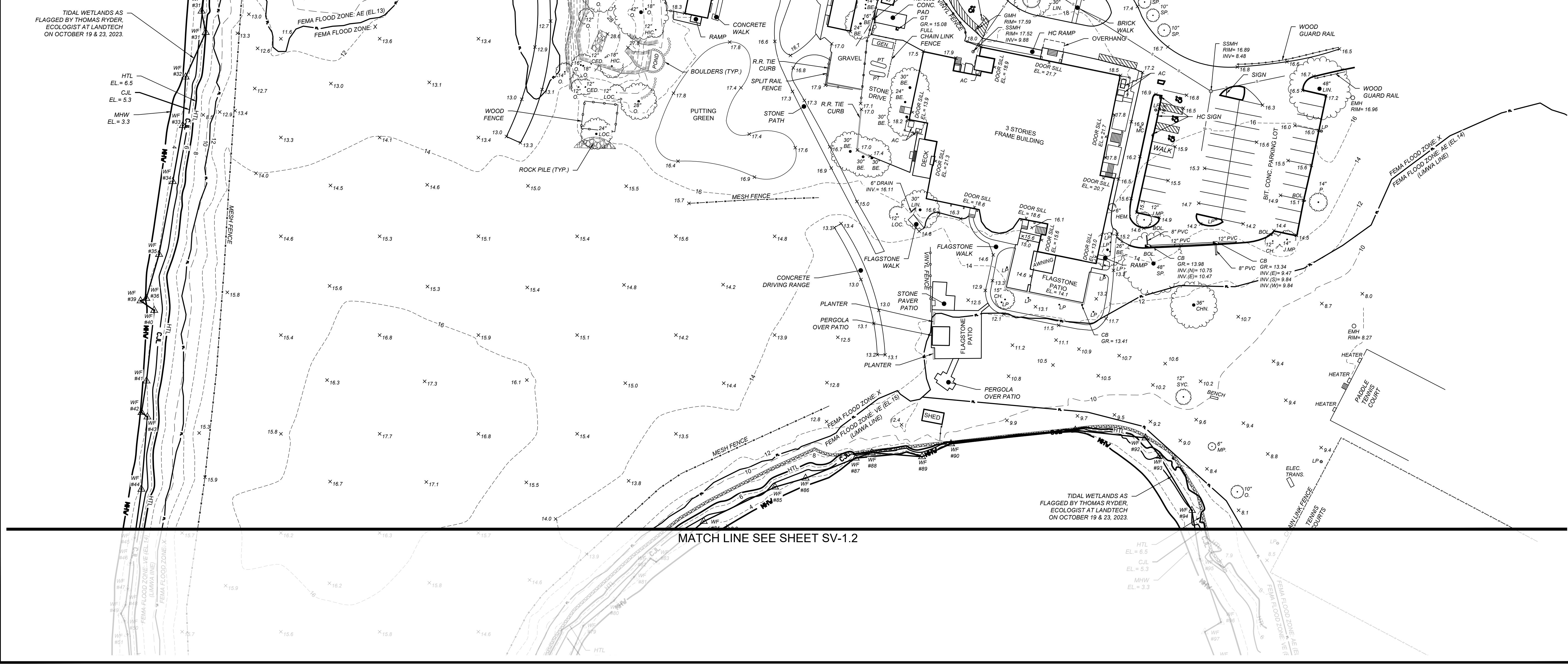

LANDTECH

THIS ACTIVE PROJECT DRAWING IS FROM: INN AT LONGSHORE 260 COMPO ROAD, WESTPORT, CT. DATE: 10/31/2023. DRAWN BY: L.A.M. CHECKED BY: T.A.D. SCALE: 1" = 40'. PROJECT NO: 21240-01.

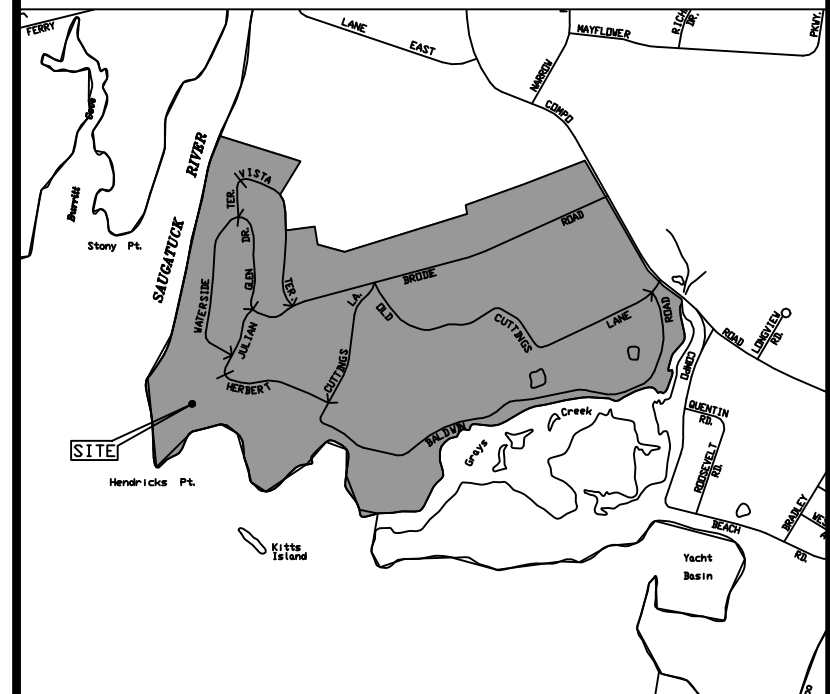
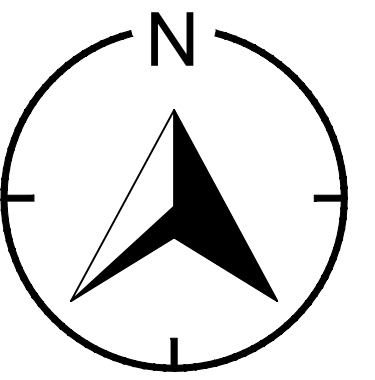

LOCATION MAP
SCALE: 1" = 1500'

PROPERTY INFORMATION:
OWNER: TOWN OF WESTPORT
CO-OWNER: LONGSHORE
ADDRESS: 260 COMPO ROAD SOUTH
WESTPORT, CT

ZONE: RESIDENCE "AAA"
DEED: BK. 172 PG. 585

MAP: C04
LOT: 001

REVISION DATE: _____ ISSUE: _____

LANDTECH
SITE/CIVIL • ENVIRONMENTAL • SURVEYING • PLANNING
518 RIVERSIDE AVENUE • WESTPORT, CT 06880 • 203-454-2110
HELLO@LANDTECHCONSULT.COM • WWW.LANDTECHCONSULT.COM

PREPARED FOR:
INN AT LONGSHORE

PROJECT LOCATION:
**260 COMPO ROAD SOUTH
WESTPORT, CT**

DRAWING TITLE:
PARTIAL TOPOGRAPHIC SURVEY

PROJECT No. **21240-01**

DATE: 10/31/2023 DRAWN BY: L.A.M. CHECKED BY: T.A.D.

SCALE: 1" = 50'
IN FEET
0 40 80 120

TO MY KNOWLEDGE AND BELIEF THIS MAP IS SUBSTANTIALLY CORRECT AS NOTED HEREON

THOMAS A. DEILUS, LAND SURVEYOR
CT. REGISTRATION NO. 70098
THE SURVEY AND DECLARATION SHOWN HEREON IS NULL AND VOID WITHOUT THE LICENSED SURVEYOR'S LIVE SIGNATURE AND SEAL.

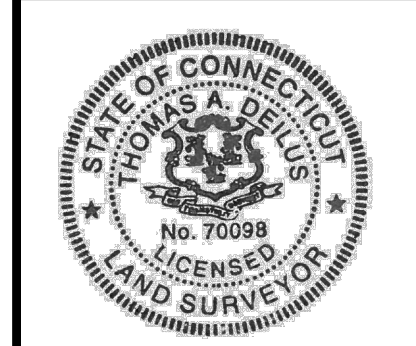

SV-1.2

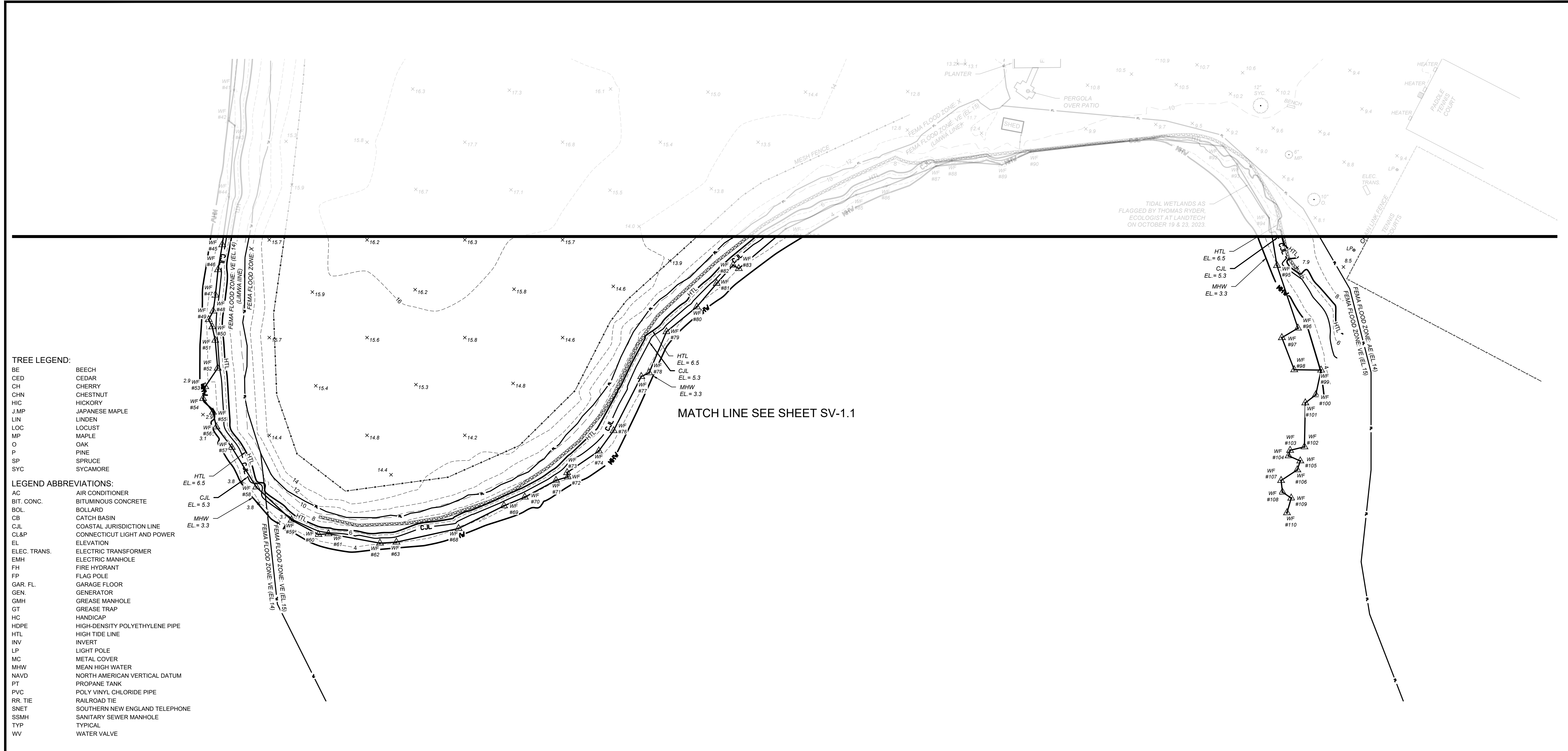

- TREE LEGEND:**
- BE BEECH
 - CED CEDAR
 - CH CHERRY
 - CHN CHESTNUT
 - HIC HICKORY
 - J.M.P JAPANESE MAPLE
 - LIN LINDEN
 - LOC LOCUST
 - MAP MAPLE
 - O OAK
 - P PINE
 - SP SPRUCE
 - SYC SYCAMORE
- LEGEND ABBREVIATIONS:**
- AC AIR CONDITIONER
 - BIT. CONC. BITUMINOUS CONCRETE
 - BOL BOLLARD
 - CB CATCH BASIN
 - C.J.L COASTAL JURISDICTION LINE
 - CL&P CONNECTICUT LIGHT AND POWER
 - EL ELEVATION
 - ELEC. TRANS. ELECTRIC TRANSFORMER
 - EMH ELECTRIC MANHOLE
 - FH FIRE HYDRANT
 - FP FLAG POLE
 - GAR. FL. GARAGE FLOOR
 - GEN. GENERATOR
 - G.M.H GREASE MANHOLE
 - GT GREASE TRAP
 - HC HANDICAP
 - HDPE HIGH-DENSITY POLYETHYLENE PIPE
 - HTL HIGH TIDE LINE
 - INV INVERT
 - LP LIGHT POLE
 - MC METAL COVER
 - MHW MEAN HIGH WATER
 - NAVD NORTH AMERICAN VERTICAL DATUM
 - PT PROPANE TANK
 - PVC POLY VINYL CHLORIDE PIPE
 - RR TIE RAILROAD TIE
 - SNET SOUTHERN NEW ENGLAND TELEPHONE
 - SSMH SANITARY SEWER MANHOLE
 - TYP TYPICAL
 - WV WATER VALVE

SYMBOLS	DESCRIPTION
	SEWER MANHOLE
	CATCH BASIN
	UTILITY POLE
	LIGHT POLE
	FIRE HYDRANT
	WATER VALVE
	PROPERTY LINE
	CONTOUR
	SPOT ELEVATION
	WETLAND FLAG

- SURVEY NOTES:**
- THIS SURVEY AND MAP HAS BEEN PREPARED IN ACCORDANCE WITH THE REGULATIONS OF CONNECTICUT STATE AGENCIES, SECTIONS 20-300b-1 THROUGH 20-300b-20, AND THE "MINIMUM STANDARDS FOR SURVEYS AND MAPS IN THE STATE OF CONNECTICUT" AS ADOPTED BY THE CONNECTICUT ASSOCIATION OF LAND SURVEYORS, INC., ON OCTOBER 26, 2016.
 - THIS SURVEY IS A ZONING LOCATION & TOPOGRAPHIC SURVEY WITH THE BOUNDARY DETERMINATION CATEGORY OF WHICH IS A RESURVEY CONFORMING TO HORIZONTAL ACCURACY CLASS "A" - 2" AND VERTICAL ACCURACY CLASS T - 2" AND IS INTENDED TO DEPICT OR NOTE THE POSITION OF EXISTING OR PROPOSED IMPROVEMENT WITH RESPECT TO APPLICABLE MUNICIPAL SETBACK REQUIREMENTS IN ORDER TO ENABLE DETERMINATION OF COMPLIANCE WITH SAID REGULATIONS.
 - THIS SURVEY WAS PREPARED FOR A SPECIFIC PURPOSE. ANY USE OTHER THAN FOR THAT WHICH WAS INTENDED IS A MISUSE OF THIS INFORMATION AND RENDERS THE PREPARER'S DECLARATION NULL AND VOID.
 - UNDERGROUND IMPROVEMENTS OR ENCROACHMENTS IF ANY ARE NOT SHOWN.
 - UNAUTHORIZED ALTERATIONS OR ADDITIONS TO THIS SURVEY, WHICH BEARS THE SURVEYORS STAMP OF SEAL, RENDERS ANY DECLARATION SHOWN HEREON NULL AND VOID.
 - THIS DECLARATION SHOWN RUNS TO THE PERSON, OR PERSONS FOR WHOM THE SURVEY WAS PREPARED FOR THIS DECLARATION IS NOT TRANSFERABLE.
 - VERTICAL DATUM: NAVD 88
 - TIDAL WETLANDS AS FLAGGED BY THOMAS RYDER ECOLOGIST AT LANDTECH, OCTOBER 19 & 23, 2023.
 - PARTIAL SUBJECT PROPERTY IS LOCATED IN FEMA FLOOD HAZARD ZONE "AE" (EL.13), "AE" (EL.14), "VE" (EL.14) AND "VE" (EL.15) AND ZONE "X" AS SHOWN ON FEMA FIRM PANEL No. 09001C 0551G, EFFECTIVE JULY 8, 2013.
 - THE SUBJECT PROPERTY IS LOCATED WITHIN A FEMA DESIGNATED SPECIAL FLOOD HAZARD AREA COASTAL A ZONE AS SHOWN ON MAP/PANEL 09001C 0551G, EFFECTIVE JULY 8, 2013. THE LIMIT OF MODERATE WAVE ACTION (LIMWA) LINE SHOWN INDICATES THE INLAND LIMIT OF THE COASTAL A ZONE.

LANDTECH

T:\11 ACTIVE PROJECTS\24241-FIN- INN AT LONGSHORE-260 COMPO RD. WESTPORT SURVEY\IN- AT LONGSHORE - 260 COMPO ROAD SURVEY.DWG