

VICINITY MAP
Scale: 1" = 500'

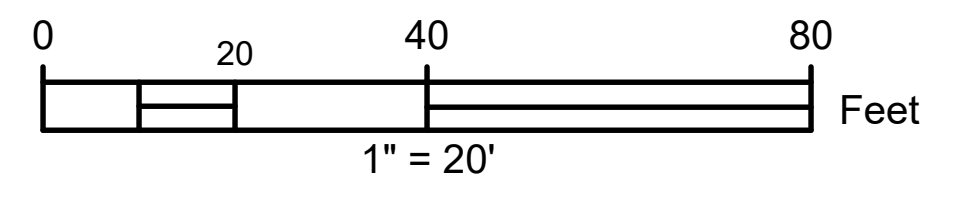
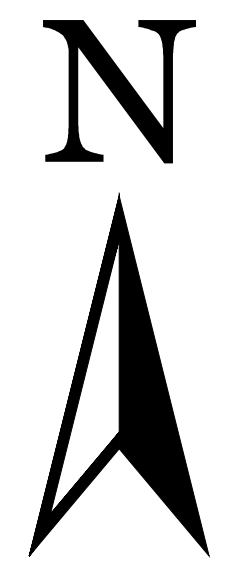

LEGEND

- EXISTING ASPHALT
- PROPOSED ASPHALT
- PROPOSED PARKING STRIPE
- PROPOSED RETAINING WALL
- EXISTING TREE TO REMAIN
- EXISTING TREE TO BE REMOVED
- EXISTING TREE TO BE RELOCATED

SPACES NOT INCLUDED IN PARKING TOTALS
(NO WORK PROPOSED)

JESUP ROAD

JESUP GREEN SITE PLAN
PREPARED FOR
TOWN OF WESTPORT
JESUP ROAD
WESTPORT, CONNECTICUT
FEBRUARY 15, 2024

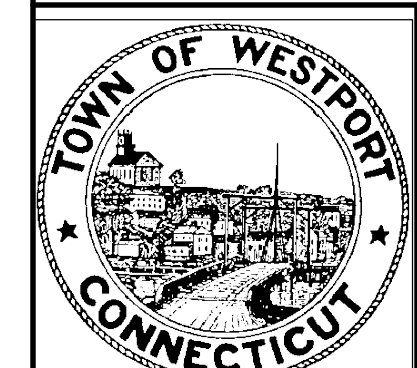

TOWN OF WESTPORT
DEPARTMENT OF PUBLIC WORKS
ENGINEERING DIVISION

TOWN HALL, 110 MYRTLE AVENUE
WESTPORT CONNECTICUT 06880
203.341.1120
(f) 203.454.5783
www.westportct.gov

PROJ. No.:	2022-02	DATE:	02/15/24
DRAWN BY:	MMN	REV:	
CHECKED BY:	KSW	REV:	
SCALE: 1" = 20'			
DRAWING NAME: JESUP GREEN - NISKI EDITS			

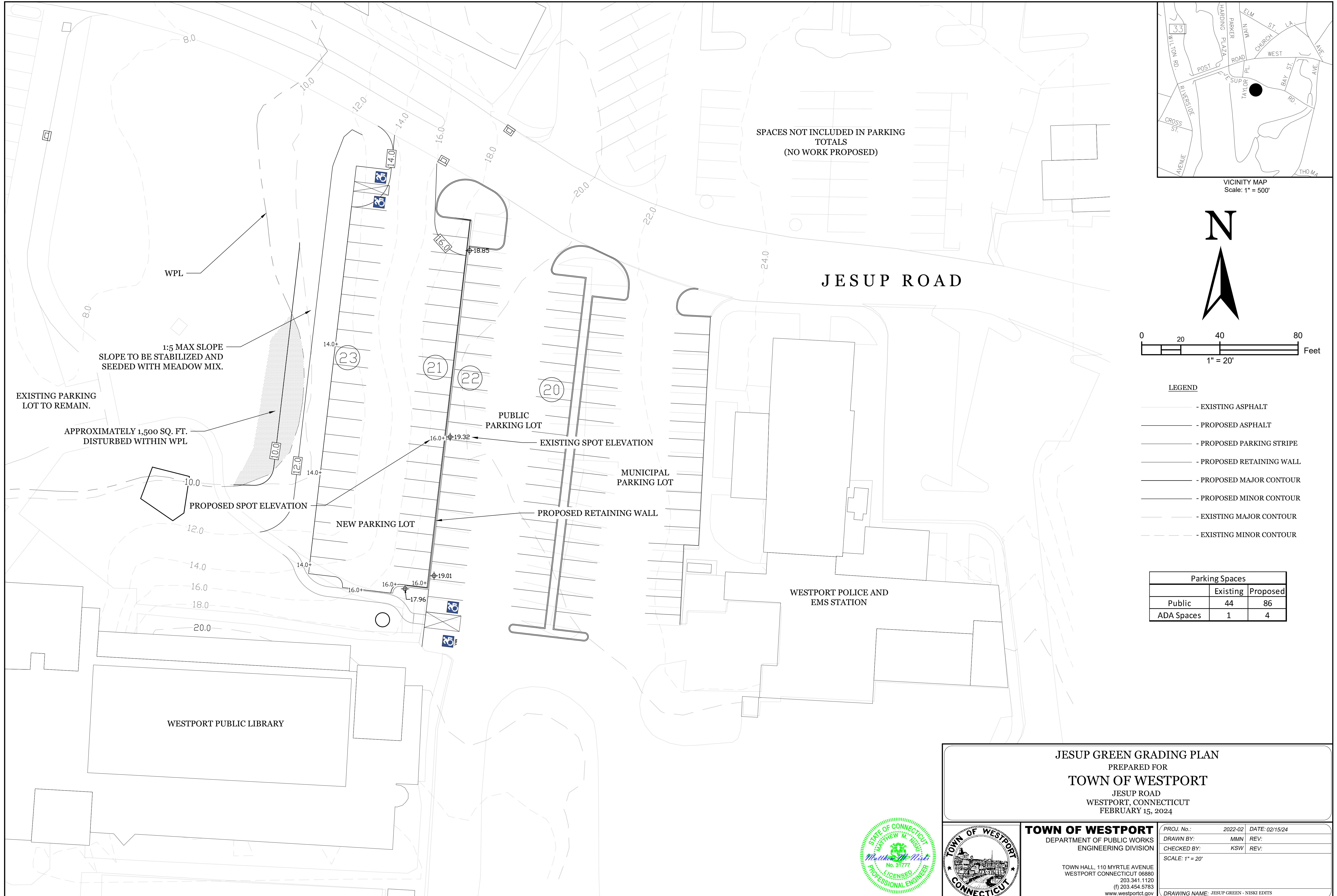

SPACES NOT INCLUDED IN PARKING TOTALS
(NO WORK PROPOSED)

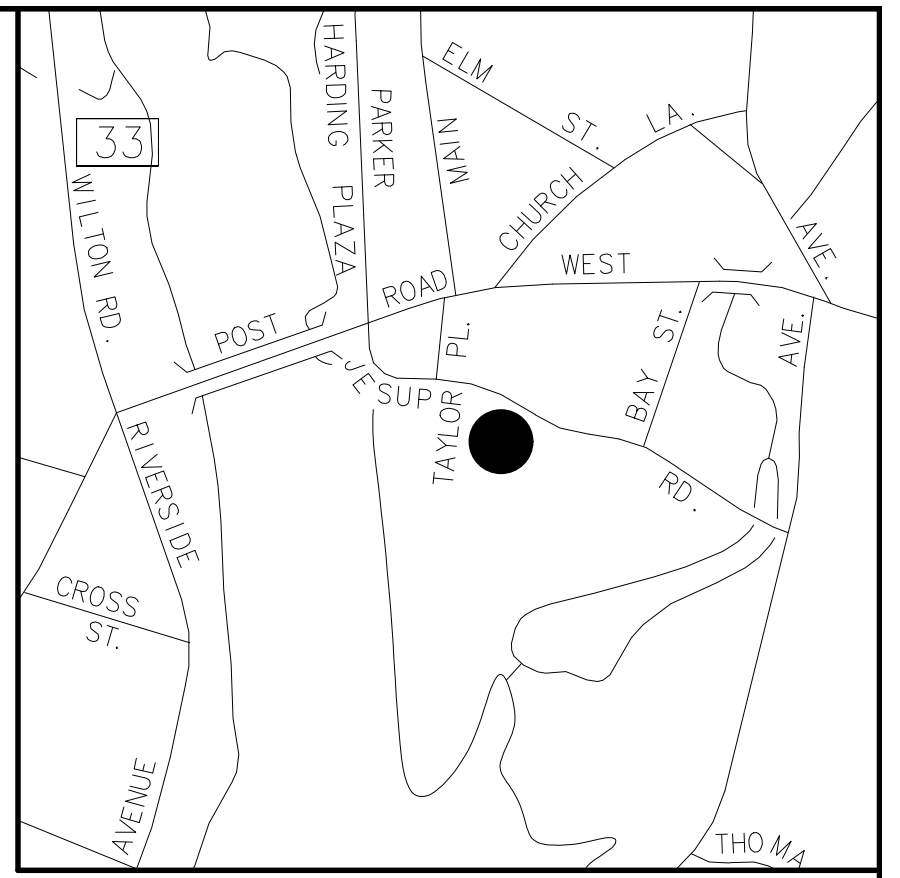

VICINITY MAP
Scale: 1" = 500'

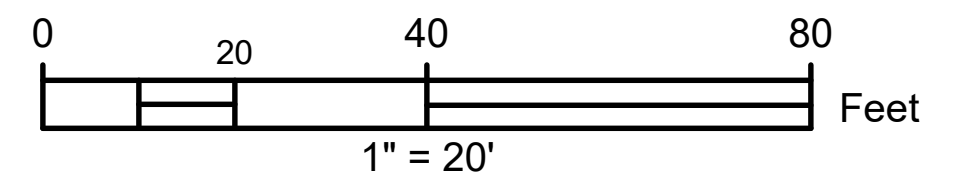
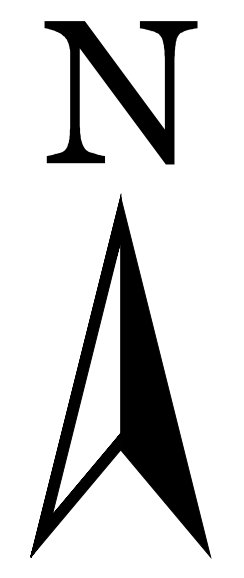

LEGEND

- EXISTING ASPHALT
- PROPOSED ASPHALT
- PROPOSED PARKING STRIPE
- PROPOSED RETAINING WALL
- PROPOSED MAJOR CONTOUR
- PROPOSED MINOR CONTOUR
- EXISTING MAJOR CONTOUR
- EXISTING MINOR CONTOUR

Parking Spaces		
	Existing	Proposed
Public	44	86
ADA Spaces	1	4

JESUP GREEN GRADING PLAN
 PREPARED FOR
TOWN OF WESTPORT
 JESUP ROAD
 WESTPORT, CONNECTICUT
 FEBRUARY 15, 2024

TOWN OF WESTPORT
 DEPARTMENT OF PUBLIC WORKS
 ENGINEERING DIVISION

TOWN HALL, 110 MYRTLE AVENUE
 WESTPORT CONNECTICUT 06880
 203.341.1120
 (f) 203.454.5783
 www.westportct.gov

PROJ. No.: 2022-02 DATE: 02/15/24
 DRAWN BY: MMN REV:
 CHECKED BY: KSW REV:
 SCALE: 1" = 20'

DRAWING NAME: JESUP GREEN - NISKI EDITS

EXISTING PARKING LOT TO REMAIN.

1:5 MAX SLOPE
SLOPE TO BE STABILIZED AND SEEDED WITH MEADOW MIX.

APPROXIMATELY 1,500 SQ. FT. DISTURBED WITHIN WPL

PROPOSED SPOT ELEVATION

NEW PARKING LOT

PUBLIC PARKING LOT

EXISTING SPOT ELEVATION

MUNICIPAL PARKING LOT

PROPOSED RETAINING WALL

WESTPORT POLICE AND EMS STATION

WESTPORT PUBLIC LIBRARY