



WESTPORT

TOWN OF WESTPORT
REPRESENTATIVE TOWN MEETING
REPRESENTATIVE TOWN MEETING PACKET
JANUARY 2, 2024
07:30 PM



REPRESENTATIVE TOWN MEETING AGENDA

JANUARY 2, 2024
07:30 PM

Call

All Representative Town Meeting members and inhabitants of the Town of Westport are hereby notified that a meeting of the Representative Town Meeting members will be held at Town Hall, 110 Myrtle Ave. in the auditorium on Tuesday January 2, 2024, at 7:30 PM for the purposes listed below. If necessary, the meeting shall reconvene on Tuesday, January 16, 2024, to deal with any agenda items not disposed of at the adjournment of the January 2, 2024, meeting.

Attachment: [Resolutions.pdf](#)

Item # 1

To take such action as the meeting may determine, upon the recommendation of the First Selectwoman, to approve the appointment of Deputy RTM Moderator, Lauren Karpf, to serve as the Town's alternate representative to the Western Connecticut Council of Governments per subsection (b) of Section 2-4 of the Code of Ordinances, for the term effective November 2023 through November 2025.

Attachment: [_1 WestCOG Alternate Representative Request.pdf](#)

Item # 2

To take such action as the meeting may determine, upon the recommendation of the Board of Finance and a request by the Director of Human Services, to approve an appropriation of \$70,561 from the Capital and Non-Recurring Fund Account for outdoor improvements at the Westport's Center for Senior Activities (WCSA) and a vehicle to assist in the delivery of home delivered meals and other WCSA business. This is reimbursable by the Southwest Connecticut Agency on Aging - American Rescue Plan Act (ARPA) Senior Center Grant.

Attachment: [_2 DHS Approp SWCARPA.pdf](#)

Attachment: [_2 RTM Finance and HHS Committees Report.pdf](#)

Item # 3

To take such action as the meeting may determine, upon the recommendation of the Board of Finance and request by the Deputy Chief of Police, to approve an appropriation of \$362,194.37 from the Capital and Non-Recurring Fund Account for the replacement of the existing 2006 Boston Whaler "Marine II" police patrol boat.

Attachment: [_3 WPD Approp Marine II Police Patrol Boat.pdf](#)

Item # 4

To take such action as the meeting may determine, upon the recommendation of the Board of Finance and a request by the Deputy Chief of Police, to approve an appropriation of \$85,840 from the Capital and Non-Recurring Fund Account for the replacement of the two existing motors for the Marine I police patrol boat.

Attachment: [_4 WPD Approp New Motor for Marine I Police Patrol Boat.pdf](#)

Attachment: [_3 _4 RTM Committee Boat Report.pdf](#)

Item # 5

To take such action as the meeting may determine, upon the recommendation of the Board of Finance and a request by the Director of Public Works, to approve an appropriation of \$75,000 from the Capital and Non-Recurring Fund Account for the purchase of one (1) F350 Building Maintenance Service Truck.

Attachment: [_5 DPW - Approp F350 Service Truck.pdf](#)

Item # 6

To take such action as the meeting may determine, upon the recommendation of the Board of Finance and a request by the Director of Public Works, to approve an appropriation of \$250,000 from the American Rescue Plan Act (ARPA) Fund for additional Post Road bus shelters.

Attachment: [_6 DPW - Approp Bus Shelters.pdf](#)

Item # 7

To take such action as the meeting may determine, upon the recommendation of the Board of Finance and a request by the Director of

Public Works, to approve an appropriation of \$275,000 from the Sewer Reserve Fund Account for the third round of emergency repairs to the Pump Station #10 force main.

Attachment: [7 DPW - AppropEmergency Repair PS_10 Round 3.pdf](#)

Attachment: [5_6_7 RTM Public Works Finance Transit Committees Report.pdf](#)

Item # 8

To take such action as the meeting may determine, upon the request of 2 RTM members and a recommendation of the Planning and Zoning Commission, to adopt an ordinance to add an inclusionary zoning fee to Appendix C -- Fees in the Town Code, at the rate of \$5 per \$1000 in construction cost. (First reading. Full text available in the Town Clerk's Office).

Attachment: [8 Town Code Appendix C - Sec.1 Schedule of fees - Flat Fee.pdf](#)

Attachment: [8 8-2i Inclusionary zoning.pdf](#)

Attachment: [8 WAHTF.pdf](#)

**RTM Meeting
January 2, 2024**

RESOLUTIONS

(1)

RESOLVED: That the appointment of Deputy RTM Moderator, Lauren Karpf, to serve as the Town's alternate representative to the Western Connecticut Council of Governments per subsection (b) of Section 2-4 of the Code of Ordinances, for the term effective November 2023 through November 2025 is hereby approved.

(2)

RESOLVED: That upon the recommendation of the Board of Finance and a request by the Director of Human Services, the sum of \$70,561 from the Capital and Non-Recurring Fund Account for outdoor improvements at the Westport's Center for Senior Activities (WCSA) and a vehicle to assist in the delivery of home delivered meals and other WCSA business is hereby appropriated. This is reimbursable by the Southwest Connecticut Agency on Aging - American Rescue Plan Act (ARPA) Senior Center Grant.

(3)

RESOLVED: That upon the recommendation of the Board of Finance and a request by the Deputy Chief of Police, the sum of \$362,194.37 from the Capital and Non-Recurring Fund Account for the replacement of the existing 2006 Boston Whaler "Marine II" police patrol boat is hereby appropriated.

(4)

RESOLVED: That upon the recommendation of the Board of Finance and a request by the Deputy Chief of Police, the sum of \$85,840 from the Capital and Non-Recurring Fund Account for the replacement of the two existing motors for the Marine I police patrol boat is hereby appropriated.

(5)

RESOLVED: That upon the recommendation of the Board of Finance and a request by the Director of Public Works, the sum of \$75,000 from the Capital and Non-Recurring Fund Account for the purchase of one (1) F350 Building Maintenance Service Truck is hereby appropriated.

(6)

RESOLVED: That upon the recommendation of the Board of Finance and a request by the Director of Public Works, the sum of \$250,000 from the American Rescue Plan Act (ARPA) Fund for additional Post Road bus shelters is hereby appropriated.

(7)

RESOLVED: That upon the recommendation of the Board of Finance and a request by the Director of Public Works, the sum of \$275,000 from the Sewer Reserve Fund Account for the third round of emergency repairs to the Pump Station #10 force main is hereby appropriated.

(8)

RESOLVED: That upon the request of 2 RTM members and a recommendation of the Planning and Zoning Commission, an ordinance to add an inclusionary zoning fee to Appendix C – Fees in the Town Code, at the rate of \$5 per \$1000 in construction cost is hereby adopted. (First reading. Full text is as follows).

Sec. 1. - Schedule of fees.

| § | Description | Fee Amount |
|----------------------------------|----------------|------------|
| | | |
| <i>Chapter 2. Administration</i> | | |
| 2-55 | Land use fees. | |

| | | |
|---|--|---------|
| B. Zoning permits. | | |
| The fee for a zoning permit for new construction and/or alterations shall be based upon the estimated cost of the project at a rate of: | | |
| (1) For residential: | | |
| | Minimum residential permit fee: | \$40.00 |
| | \$2.00 per \$1,000.00, or part thereof, of construction cost up to \$100,000.00. | |
| | \$3.00 per \$1,000.00, or part thereof, construction cost from \$100,001.00 up to \$499,999.00. | |
| | \$4.00 per \$1,000.00, or part thereof, construction cost over \$500,000.00. | |
| (2) Special permit uses in residential zones: | | |
| | Minimum special permit fee: | \$50.00 |
| | \$3.00 per \$1,000.00, or part thereof, of construction cost up to \$100,000. | |
| | \$4.00 per \$1,000.00, or part thereof, of construction cost from \$100,001.00 up to \$499,999.00. | |
| | \$5.00 per \$1,000.00, or part thereof, of construction cost from \$500,000.00 up to \$999,999.00. | |

| | | | |
|---|--|--|---------|
| | | \$6.00 per \$1,000.00 or part thereof construction cost over \$1,000,000.00. | |
| (3) Commercial and multifamily in all zones: | | | |
| | | Minimum commercial permit fee: | \$75.00 |
| | | \$5.00 per \$1,000.00, or part thereof, of construction cost up to \$100,000.00. | |
| | | \$7.00 per \$1,000.00, or part thereof, of construction cost from \$100,001.00 up to \$499,999.00. | |
| | | \$8.00 per \$1,000.00, or part thereof, of construction cost from \$500,000.00 up to \$999,999.00. | |
| | | \$9.00 per \$1,000.00, or part thereof, of construction cost over \$1,000,000.00. | |
| (4) (a) Freestanding sign permit and zoning certificate of compliance. | | | |
| | | | \$80.00 |
| (b) Freestanding portable sign. | | | |
| | | | \$40.00 |
| (5) Wall sign permit and zoning certificate of compliance. | | | |
| | | | \$80.00 |
| (6) Conditional zoning certificate of compliance: | | | |
| | | (a) Residential. | \$40.00 |

| | | |
|--|--|--|
| | (b) Commercial and special permit uses. | \$75.00 |
| (7) Final zoning certificate of compliance: | | |
| | (a) Residential. | \$40.00 |
| | (b) New residential house. | \$75.00 |
| | (c) Commercial/multifamily/special permit uses. | \$150.00 |
| | (d) Each additional inspection will require the inspection zoning certificate of compliance fee to be charged again as listed above. | |
| (8) Zoning permit renewals. | | |
| | | All applications for the renewal of a zoning permit shall be accompanied by a fee of ten percent of the original application fee. |
| (9) Inclusionary zoning fee. | | |
| | | All applications for a zoning permit shall be accompanied by a fee to be used for constructing, rehabilitating, or repairing housing affordable to persons and families of low and moderate income pursuant to C.G.S. § 8-2i: \$5.00 per \$1,000 of construction cost |
| [Authority: "Westport Affordable Housing Trust Fund" (WAHTF) Town Ordinance approved by RTM 10/3/23; Section 45-3.6.3. of the Town Zoning Regulations approved by P&Z Commission 12/18/23] | | |
| (10) Zoning permits for approvals sought "after the fact" or for the correction of a violation shall pay double the fee listed above. | | |

| | | |
|--|--|--|
| | | |
| | | (11) When a permit is revoked due to a violation, the zoning permit fee shall be paid again before the permit can be reissued. |

(Resolution of _____, effective 14 days after publication on _____)



WESTPORT
CONNECTICUT

Jennifer S. Tooker, First Selectwoman

MEMORANDUM

To: Jeff Wieser, Moderator of the Representative Town Meeting
Jeff Dunkerton, Town Clerk

From: Jennifer S. Tooker, First Selectwoman

Date: December 18, 2023

Re: Request for Confirmation of Lauren Karpf as Alternate Rep to WestCOG

As Westport’s Chief Elected Official, I am the primary representative to the Western Connecticut Council of Governments (“WestCOG”). The State statute that established the COG structure calls for an alternate representative to be named from each municipality. The alternate must be an elected official. Westport’s ordinance adopting that statute and authorizing the Town to join a COG (Sec 2-4) confirms that the First Selectwoman shall represent the Town on the COG. In addition, it states that the RTM shall appoint one of its members as an alternate to the COG, serving two years or until the next election of members of the RTM.

I hereby request that the RTM select and confirm the appointment of RTM Deputy Moderator Lauren Karpf as the Town’s alternate representative to the Western Connecticut Council of Governments for the term effective November, 2023 through November, 2025.

RECEIVED FOR RECORD
WESTPORT TOWN CLERK
2023 DEC 18 P 4:23
Jeffrey M. Dunkerton
JEFFREY M. DUNKERTON
TOWN CLERK

Town Hall • 110 Myrtle Avenue • Westport, CT 06880 • (203) 341-1111 • Fax (203) 341-1038
Email: selectwoman@westportct.gov • Website: www.westportct.gov



WESTPORT CONNECTICUT
DEPARTMENT OF HUMAN SERVICES

Elaine Daignault, M.A., N.C.C.
Director
(203) 341-1165 email: elained@westportct.gov

TO: Jen Tooker, First Selectwoman

CC: Eileen Flug, Assistant Town Attorney
Wendy Petty, WCSA Director
Sibel Yorlumaz, DHS Finance Manager

FROM: Elaine Daignault, DHS Director

DATE: November 29th, 2023

RE: BOF REQUEST: December 6th, 2023

APPROVED: 
Jennifer S. Tooker
First Selectwoman
Date: 11/30/23

Please add the following agenda item to the December 6th, 2023 Board of Finance meeting:

A one-time appropriation in the amount of \$70,561 for Westport's Center for Senior Activities and the Southwest Connecticut Agency on Aging for **23SDRASC01WSP- American Rescue Plan Act (ARPA) Senior Center Grant**. This funding was offered to Senior Centers throughout the state and Westport applied for funding for outdoor improvements at the WCSA including a pollinator garden and a vehicle to assist in the delivery of home delivered meals and other WCSA business. The appropriation is reimbursable to the Town.

January 2nd, 2024

To take such action as the meeting may determine, upon the recommendation of the Board of Finance and a request by the Director of Human Services, to approve an appropriation of \$70,561 from the Capital and Non-Recurring Fund Account for outdoor improvements at the Westport's Center for Senior Activities (WCSA) and a vehicle to assist in the delivery of home delivered meals and other WCSA business. This is reimbursable by the Southwest Connecticut Agency on Aging - American Rescue Plan Act (ARPA) Senior Center Grant.

HHS Committee:

- Julie Whamond
- Jack Klinge
- Sal Liccione
- Kristin Schneeman
- Jennifer Johnson

Finance Committee:

- Seth Braunstein
- Don O'Day
- Rachel Cohen
- Ari Benmosche
- Nancy Kail
- Michael Perry
- Noah Hammond

For HHS:

- Wendy Petty – Director of WCS
- Elaine Daignault – Director of Human Services Department

The state has granted ARPA funds for senior centers (separate and distinct from the \$8.4M of Federal funds that came directly to the town). Westport applied and was granted \$70,561. Will be used for a pollinator pathway, a new vehicle, an improved website and other things. Designed to bring people back to the senior center post Covid.

Landscaping = ~\$36K

Outdoor Furniture = \$4k

Vehicle (electric) = \$26.7k

Website & Logos = \$3.9K

This request is to accept the appropriation. The town will expend the funds and will then be reimbursed by the state by 2026. Half of the projects are ready to go but all are expected to be completed by the end of 2024 which should accelerate the reimbursement.

Have already submitted initial plans to the state unit on aging and been approved.

For HHS – Sal Liccione moved and was seconded by Julie Whamond, Passed Unanimously

For Finance – Rachel Cohen and was seconded by Don O’Day, Passed Unanimously

Submitted by Seth Braunstein, Chairman of RTM Finance Committee



Memorandum

APPROVED: 
Jennifer E. Tooker
First Selectwoman
Date: 12/5/2023

To: Honorable Jen Tooker, First Selectwoman
CC: Gary Conrad, Finance Director; Foti Koskinas, Chief of Police
From: Deputy Chief Ryan Paulsson
Date: 12/01/2023
Re: Appropriation for the Replacement of Police Patrol Boat; Marine 2

Background

The Westport Police Department Marine Division is responsible for marine law enforcement and search and rescue activities covering 13.3 square miles of water on Long Island Sound, including 5 miles of Westport shoreline. This coverage is provided 365 days a year with officers assigned to the division (full time from May through September, staffed as needed the rest of the year). As a waterfront community, the Westport Police Department has maintained a marine patrol for well over 60 years.

The Marine Division normally has two boats available for operation. The larger boat (Marine 1) is a 33-foot 2014 NAID with a pilot house/cabin. The second boat (Marine 2) is a 25-foot, open hull, center console 2006 Boston Whaler. Both boats were purchased with expectations of a 10-year service life and were carried as such in the department's 5-year capital forecast.

Marine 2 is the primary in-season boat for the Westport Police Department and responds to all major incidents. The boat has a lower profile than Marine 1 and has a collapsible towing tower allowing it to fit under the Rt 136 Cribari bridge. This is the primary response vessel for any call for service north of the Bridge St bridge. In addition, Marine 2 has a shallow draft which allows for response to our Westport islands that can be difficult to navigate based on the changing tides. The vessel also serves as a dive platform for dive-rescue related incidents along the shoreline during the spring, summer, and early fall seasons. Marine 2 is an all-around work platform for many other duties, including maintenance of the Town of Westport's 5 Mile per hour enforcement buoys, recovery of debris deemed a hazard to navigation, and assisting with channel markers and fireworks moorings when needed.

December 4, 2023

An aggressive preventive maintenance program allowed us to keep Marine 2 in service for nearly 17 years. The boat is showing signs of needing overhaul. Stress fractures in the fiberglass are observable and de-lamination of the interior foam is evident. The replacement of critical mechanical and electrical components will be needed as well. Any repair, if possible, would only get temporary extension of life and ultimately be cost prohibitive. The motors for Marine 2 have reached 700 hours and would need replacement at the end of the 2024 season.

Comparative Options

When looking at replacement options we filtered the search by looking for vessels that would meet the minimum following criteria:

- Height requirements for passage under both the Saugatuck RR bridge and the Rt 136 Cribari bridge at high tides.
- Shallow draft to navigate the Westport islands and low water areas that surround them.
- Towing tower with protective barrier to prevent injury when vessels are under tow. (60 years ago, a Westport Police Officer was killed in the line of duty when working as a marine officer and a tow line snapped striking him in the head.)
- Workable platform to support dive / rescue operations.
- Equipped with modern electronics (navigation, search and rescue, etc.)
- Proven track record in waters similar to Long Island Sound

Three boat manufacturers in the field of police patrol boats were evaluated on how their products would meet with our needs. The three companies reviewed were SAFE boats International, Brunswick \ Boston Whaler, and FLUID watercraft. NAID, the manufacturer of our Marine 1, would have been considered but is no longer in business.

Brunswick \ Boston Whaler products have been used by the Westport Police Department for the last 30 years and have been a highly reliable product. Unfortunately, they have significantly scaled back their commercial product line, choosing to focus on recreational products. They no longer manufacture towing towers and do not provide "diver's doors", or gunwale cut outs for in-water recovery. The hulls are fiberglass and if not re-enforced during the manufacturing process, any aftermarket addition would be at significant risk of failure and not covered by any warranty.

FLUID Watercraft is the current model of our shell fishing enforcement boat. It is classified as a Rigid Inflatable Boat (RIB) meaning it has a fiberglass hull with a wraparound inflatable collar. This is a great platform for navigating shallow waters. The wrap around collar is good for coming alongside other vessels or people shell fishing in waist deep water. FLUID provides for a tow post,

December 4, 2023

but any tower would have to be engineered as they have never equipped one of their vessels before. The inflatable collar is not foam filled therefore it relies on air pressure to keep its shape and functionality. The air collar is not ideal when working on moorings or needing to pull people out of the water. Any puncture or deflation of the collar would result in the boat being out of service until repaired. Further, it is not recommended to keep a RIB vessel in direct sunlight, as the exposure to UV rays will start to degrade the collar overtime. Because this is a primary response vessel, it would not be practical to keep it covered prior to needing it. The working space of the deck is significantly smaller than the other vessels evaluated.

SAFE Boats International has quickly become the industry standard for public safety marine operations over the last 20 years. SAFE Boats are utilized by the following agencies who operate in Long Island Sound. Most of these agencies have been spoken to about their vessels and they all responded with very high recommendations.

- US Coast Guard Station Eaton's Neck and Station Long Island Sound
- Fairfield Marine Police
- Norwalk Marine Police
- Darien Marine Police
- Stamford Marine Police
- Greenwich Marine Police
- Stratford Marine Police
- Nassau County, NY
- Suffolk County, NY
- Sea Tow (Commercial towing company, not public safety)

The vessel has an aluminum hull which is durable and safe. Damage can be isolated and repaired without compromising the entire hull. As we have seen with the existing Marine 2, cracks in the fiberglass do occur and water can enter the lamination, creating hull instability. This does not occur with aluminum hulls. Marine 1 has an aluminum hull and we have not seen any examples of maintenance becoming more expensive or difficult for aluminum hulled boats. SAFE boat vessels are equipped with a 100% closed cell foam collar system and provide for a redundant level of buoyancy above and beyond the hull design. These full buoyancy flotation collars are required to enable the boat to remain afloat with no additional flotation in the event of a catastrophic hull breach. In addition to providing more buoyancy, the collar is designed to protect the entire side of hull giving additional protection when coming alongside other vessels and provides lateral stability by touching the water while at rest.

December 4, 2023

SAFE boats have a wider beam and larger working spaces fore and aft of the console. The vessel will have a collapsible towing tower with protective guard. The hull is equipped with a reinforced keel that protects the hull when beached, when operating in shallow water, or navigating the numerous underwater obstacles and reefs that make up the geography of our patrol areas. The vessel is equipped with state-of-the-art search and rescue electronics, including side scan sonar, FLIR thermal imaging, and navigational chart plotters. There are diver cutouts on either side of the boat that facilitate pulling people out of the water.

SAFE Boats come with a 15-year hull warranty which is the longest offered from the vendors evaluated.

Costs

Quotes were received from all three companies and all quotes include boat, motors, and trailer. All quotes include government pricing.

| | |
|---------------------------|---|
| SAFE Boats International | \$344,947.02 |
| Brunswick \ Boston Whaler | \$255,905.00 (Price w/o FLIR, Tow Tower, Divers Door, other features) |
| FLUID watercraft | \$178,877.58 (Price w/o FLIR, Tow Tower, Divers Door, other features) |

Selection

After reviewing the options and speaking with other departments in our area, we recommend SAFE Boat International as the company to use in moving forward with this replacement project. Some of the major reasons for this recommendation include:

- Meets and exceeds the minimum criteria for public safety marine operations in Westport (height requirements, shallow water capabilities, safe towing design, large work area to support a variety of operations)
- 15-year Hull warranty (Longest Hull Warranty)
- Proven track record in LIS and highly recommended by our Public Safety Partners in the area
- Purpose built for public safety / search and rescue
- Reliability and rugged construction
- Customer service and responsiveness

Although at the highest price point, SAFE Boats have proven longevity in the field. Some SAFE Boats operating in our area have been in service for over 15 years, with one nearing 20 years of service. The Westport Police Department has a reputation for extending the life of our Marine fleet assets far beyond their anticipated replacement dates. Traditionally we have placed Marine replacement on a 10-year schedule. It is anticipated, based upon the feedback we are receiving, that this can be pushed back to a 15-year schedule.

December 4, 2023

Total Appropriation Request

The Police Department respectfully requests an appropriation in the amount of \$344,947.02 for the replacement of the existing 2006 Boston Whaler "Marine 2" from the Capital & Nonrecurring Expenditure Fund. Due to potential manufacturing issues or delays, we respectfully request a 5% contingency of \$17,247.35 added to this project.

Total appropriation amount \$362,194.37



SAFE Boats International
 8800 SW Barney White Rd
 Bremerton, WA 98312
 t: (360) 674-7161 f: (360) 674-7149

QUOTE

Number AAAQ4740
 Date Dec 1, 2023
 Expiration Date Jan 30, 2024
 Salesperson Robert Goley

Sold To
 Westport Police Department
 Brendan Fearon
 50 Jesup Road

 Westport, CT 06880

 Phone 2033688948
 Fax

Ship To
 Westport Police Department
 Brendan Fearon
 50 Jesup Road

 Westport, CT 06880

 Phone 2033688948
 Fax

| Line | Code | Description | Qty | Price | Ext. Price |
|------|------------|---|-----|--------------|--------------|
| 1 | NSO-125-14 | <p>SAFE 25 CENTER CONSOLE</p> <p>SALES DESCRIPTION: INTERNAL DESCRIPTION SAFE 25 CENTER CONSOLE SPECIFICATIONS LENGTH OVERALL (LOA) (NO ENGINES): 25' LENGTH OVERALL (METERS): 7.6M BEAM OVERALL (BOA): 8'-6" BEAM OVERALL (METERS): 2.6M DEADRISE AT TRANSOM: 25 DEG DRAFT (ENGINE TRIMMED UP): 19" MAX HP: 450 FUEL CAP. (GAL): 150 MAX NUMBER OF PERSONS: 15 SEATED POSITIONS: 6 DRY WEIGHT: VESSEL, NO ENGINES, NO FUEL, NO OPTIONS, NO LIQUIDS, NO PEOPLE, NO CARGO, (APPROXIMATE): 4,798 LBS</p> <p>HULL & DECK -1/4" - 5086 BOTTOM PLATE WITH SAFE BOATS EXCLUSIVE STRINGER SYSTEM WITH ANGLED TRANSVERSE FRAMING -PRESSURE TESTED AIR TIGHT HULL -REINFORCED KEEL BEACHING PLATE -NOTCHED TRANSOM WITH SPEED SHOE IN BOTTOM PLATE -PERFORMANCE WINGS BELOW COLLARS FOR INCREASED LIFT AND STABILIZATION WHILE MANEUVERING -FULLY WELDED PERFORMANCE LIFTING STRAKES -SELF BAILING DECKS WITH HIGH VOLUME SCUPPER DRAINS -BOW STORAGE/ANCHOR LOCKER WITH AFT FACING DOOR -DUAL AFT RIGGING LOCKER SYSTEM WITH TOPSIDE ACCESS -SACRIFICIAL HULL ANODE(S)</p> <p>SUPER STRUCTURE -44-INCH CENTER CONSOLE WITH REMOVABLE DASH-FACE AND INTERIOR ACCESS WITH FWD FACING GASKETED ALUMINUM DOOR -LEXAN WINDSCREEN -SAFETY HAND/GRAB RAIL SYSTEM WITH BLACK RUBBERIZED RAIL WRAP</p> <p>CONSOLE & DASH -PORT SIDE HELM</p> <p>SEATING, SEAT STORAGE & UPHOLSTERY -TWO (2) FLIP UP SEATS WITH SEAT BELTS MOUNTED ON BOLSTER</p> | 1 | \$203,660.63 | \$203,660.63 |

12/01/23 11:04:58

1 of 6

| Line | Code | Description | Qty | Price | Ext. Price |
|------|----------------------|---|-----|------------|------------|
| | | <p>STORAGE BOX -AFT STORAGE BOLSTER WITH LARGE AFT FACING GASKETED ALUMINUM DOORS</p> <p>COLLAR SYSTEM -PATENTED 100% FOAM SAFE XDR-1 EXTREME DUTY REINFORCED COLLAR SYSTEM WITH BLACK RUBSTRAKE -AVAILABLE COLLAR COLORS INCLUDE: BLACK, BLUE, GRAY, ORANGE, GREEN, RED</p> <p>COATINGS, COVERINGS & LETTERING -BLACK NON-SKID DECKS AND GUNNELS -BLACK RUBBERIZED DASH SKID</p> <p>TOWING, LIFTING & ATTACHMENT POINTS -SIX (6) 10" CAST ALUMINUM WELD ON CLEATS -BOW AND STERN LIFTING EYES -WELD ON BOW EYE WITH DUAL SS INSERTS -SS BOLT ON TRANSOM TIE DOWNS -FORE AND AFT TOW POSTS WITH SINGLE SS CROSS PIN</p> <p>ELECTRICAL SYSTEM & POWER GENERATION -HOUSE BATTERY SYSTEM 12VDC - ONE (1) MARINE GRADE BATTERY WITH SWITCH -BLUE SEA 360 MARINE GRADE BREAKER SYSTEM -BACKLIT SWITCH PANEL WITH MARINE GRADE SWITCHES -TWO (2) 12VDC POWER RECEPTACLES ON DASH</p> <p>LIGHTING -LED NAVIGATION LIGHTS (RUNNING AND ANCHOR) -INDEPENDENTLY CONTROLLED INTERIOR/EXTERIOR DIMMABLE LED WALKWAY LIGHTS -ONE (1) 12VDC RECHARGEABLE FLASHLIGHT</p> <p>ELECTRONICS, NAVIGATION & COMMUNICATION -MAGNETIC COMPASS W/ DIMMABLE BACK-LIGHTING -NAVIGATION HORN</p> <p>SAFETY, RESCUE & DIVING EQUIPMENT -TWO (2) FIRE EXTINGUISHERS -LIFE RING MOUNT</p> <p>FUEL SYSTEM -150 - GALLON FUEL TANK WITH A FORMED BOTTOM (1/4" - 5086)</p> | | | |
| 2 | DWS-86CC | <p>DELETE WINDSCREEN ON SAFE 86 CC. INCLUDES: DELETION OF WINDSCREEN FROM BASE BOAT.</p> | 1 | -\$806.65 | -\$806.65 |
| 3 | NSO-WPD225-1 | <p>ADD AFT LOCKER ELECTRONICS HINGE ARCH WITH TOW GUARD ON SAFE 86 WIDE BOAT. INCLUDES: MODIFICATIONS TO AFT LOCKER AND GUNNELS TO ADD ATTACHMENT STRUCTURE, ANCHOR LIGHT MOUNTING BRACKET, NECESSARY HARDWARE, ADDITIONAL MATERIALS AND INSTALLATION.</p> | 1 | \$3,894.49 | \$3,894.49 |
| 4 | RWBK | <p>NOTE: ELECTRONICS SOLD SEPARATELY. BLACK RUBBERIZED RAIL WRAP. BLACK RUBBERIZED RAIL WRAP.</p> | 1 | \$0.00 | \$0.00 |
| 5 | SEADEK-BK/GY-H D-225 | <p>UPGRADE TO SEADEK 8MM HD MARINE DECK COVERING, 1" PIN LINE SAFE 25 CC. INCLUDES: UPGRADE FROM STANDARD BASE BOAT STICK-ON NON-SKID TO CUSTOM CUT SEADEK WITH 1" PIN LINE, 8MM HIGH DENSITY, COLOR: MIDNIGHT BLACK (TOP LAYER) / STORM GRAY (BOTTOM LAYER), INSTALLED ON ALL EXTERIOR SURFACES, NECESSARY HARDWARE AND INSTALLATION.</p> | 1 | \$6,408.35 | \$6,408.35 |

12/01/23 11:04:58

2 of 6

| Line | Code | Description | Qty | Price | Ext. Price |
|------|----------|--|-----|-------------|-------------|
| 6 | RSBK | BLACK RUB-STRAKE BLACK RUB-STRAKE | 1 | \$0.00 | \$0.00 |
| 7 | DSBK | BLACK RUBBERIZED DASH SKID BLACK RUBBERIZED DASH SKID | 1 | \$1,082.63 | \$1,082.63 |
| 8 | CCBK | COLLAR COLOR BLACK COLLAR COLOR BLACK | 1 | \$0.00 | \$0.00 |
| 9 | AS6300-2 | ALLSALT 6300 SUSPENSION WIDE SEAT, HEIGHT ADJUST, 2" WIDER ARMRESTS, BLACK UPHOLSTERY. INCLUDES: (1) FOLD-DOWN 6300 WIDE SEAT BUCKET WITH 8" SUSPENSION TRAVEL, CLEAR ANODIZED ALUMINUM METAL, BLACK MARINE GRADE UPHOLSTERY, HEIGHT ADJUSTMENT, 2" WIDER ARMRESTS, LAPBELT, CUP HOLDER. | 1 | \$7,408.49 | \$7,408.49 |
| 10 | CID-1 | COLLAR ID - MIDSHIPS COLLAR IDENTIFICATION - MIDSHIPS. INSTALL AGENCY NAME IN ADHESIVE VINYL LETTERING TO COLLAR MIDSHIPS, PORT AND STARBOARD. LETTERING INCLUDES 6" BLOCK LETTERS IN SINGLE SOLID COLOR. CUSTOM COLORS AND REFLECTIVE MATERIAL AVAILABLE FOR AN ADDITIONAL CHARGE. PLEASE INCLUDE REQUESTED NAME AND COLOR IN SALES NOTES. | 1 | \$348.30 | \$348.30 |
| 11 | CID-4 | "POLICE" In 6-inch white lettering. INSTALL (1) CUSTOMER SUPPLIED AGENCY LOGO/SHIELD DECAL. INCLUDES: INSTALLATION OF (1) CUSTOMER SUPPLIED AGENCY LOGO/SHIELD DECAL. PLACEMENT TO BE DESCRIBED IN SALES NOTES ON QUOTE. Agency shields placed on port and starboard sides of the console. | 2 | \$216.53 | \$433.06 |
| 12 | DLPRCP | DIVE LADDER PRC PLATFORM DIVE LADDER PRC PLATFORM WITH LOCKING PINS AND LANYARDS. | 1 | \$1,452.69 | \$1,452.69 |
| 13 | DLG4 | DIVE LADDER SS GARELICK 4-RUNG W/ STORAGE MOUNT. DIVE LADDER SS GARELICK 4-RUNG WITH MOUNT ON PORT SIDE OF OUTBOARD BRACKET. INCLUDES STORAGE MOUNT WHILE NOT IN USE, NECESSARY HARDWARE AND INSTALLATION. | 1 | \$1,479.48 | \$1,479.48 |
| 14 | PRC-8.5 | SAFE 8FT 6IN BEAM BOATS PERSONNEL PERSONNEL RECOVERY SIDE PLATE AND COLLAR CUTOUTS. FACILITATES PIW RECOVERY. | 1 | \$1,676.37 | \$1,676.37 |
| 15 | DTH4 | 4 TANK ROLL-CONTROL DIVE TANK HOLDERS. FOUR (4) ROLL-CONTROL DIVE TANK HOLDERS MOUNTED ON AFT LOCKERS. INCLUDES NECESSARY HARDWARE AND INSTALLATION. | 1 | \$405.51 | \$405.51 |
| 16 | MV250-1 | MERCURY VERADO 250 INCLUDES: (1) MERCURY VERADO (DIGITAL SHIFT & THROTTLE) 250 ENGINE, (1) SS PROP | 2 | \$25,756.03 | \$51,512.06 |
| 17 | ERV2 | MERCURY VERADO TWIN ENGINE RIGGING. VERADO TWIN ENGINE RIGGING. RIGGING INCLUDES: HYDRAULIC POWER STEERING, TIE BAR, SS PROP, DUAL BINNACLE, STEERING WHEEL, SAFETY LANYARD, VESSEL VIEW DIGITAL GAUGE, TWO ADDITIONAL STARTING BATTERIES AND INSTALLATION/LABOR. | 1 | \$16,193.37 | \$16,193.37 |

12/01/23 11:04:58

3 of 6

| Line | Code | Description | Qty | Price | Ext. Price |
|------|--------------------|---|-----|-------------|-------------|
| 18 | GPSMAP8612xsv | GARMIN GPSMAP 8612XSV 12" TOUCH HD CHARTPLOTTER/SONAR COMBO WITH PRELOADED HD MAPS INCLUDES: (1) GARMIN 010-02092-03 GPSMAP 8612XSV 12" HD TOUCHSCREEN CHARTPLOTTER/SONAR COMBO WITH BUILT-IN SUPPORT FOR SONAR, INCLUDING DUAL-CHANNEL 1 KW TRADITIONAL CHIRP, CHIRP CLEARVU AND CHIRP SIDEVU SCANNING SONARS PLUS BUILT-IN SUPPORT FOR ULTRA HIGH-DEFINITION SCANNING SONAR (NO BLACK BOX REQUIRED), PRELOADED BLUECHART G3 US COASTAL & LAKEVU HD MAPS, NECESSARY HARDWARE AND INSTALLATION. (TRANSDUCER(S) AND EXTERNAL GPS ANTENNA SOLD SEPARATELY). | 1 | \$4,340.10 | \$4,340.10 |
| 19 | GPS24xdNMEA2000 | GARMIN GPS 24XD NMEA 2000 POSITION RECEIVER & ANTENNA W/ MULTI-BAND GNSS & HEADING. INCLUDES: (1) GARMIN 010-02316-10 GPS 24XD NMEA 2000 POSITION RECEIVER AND ANTENNA WITH MULTI-BAND GNSS AND HEADING, NECESSARY HARDWARE AND INSTALLATION. | 1 | \$462.42 | \$462.42 |
| 20 | GT51M-TM-86 | GARMIN GT51M-TM TRANSOM MOUNT CHIRP DOWNVU/SIDEVU TRANSDUCER ON GARMIN GT51M-TM TRANSOM MOUNT CHIRP DOWNVU/SIDEVU TRANSDUCER ON SAFE 8'6" WIDE BOATS. INCLUDES: (1) GARMIN GT51M-TM TRANSOM MOUNT DOWNVU/SIDEVU TRANSDUCER (12-PIN), 500W (CHIRP 260/455 KHZ) TRADITIONAL 600W (MID-BAND CHIRP 80-160 KHZ) WITH TEMP, NECESSARY HARDWARE AND INSTALLATION. | 1 | \$827.02 | \$827.02 |
| 21 | FLIRM364C | FLIR M364C DUAL PAYLOAD STABILIZED 640 THERMAL 24 DEG FOV & HD COLOR LOW-LIGHT CAMERA W/O JCU. INCLUDES: (1) FLIR E70518 M364C DUAL PAYLOAD, STABILIZED THERMAL CAMERA (640 X 480, 30HZ, 24 DEG FOV) AND COLOR LOW LIGHT CAMERA WITH PAN, TILT AND ELECTRONIC ZOOM, (1) SBI FABRICATED FLIR M300 SERIES WELD-ON RISER BRACKET INSTALLED ON CABIN TOP, NECESSARY HARDWARE AND INSTALLATION. FLIR JOYSTICK CONTROL UNIT (JCU) SOLD SEPARATELY. | 1 | \$24,531.35 | \$24,531.35 |
| 22 | FLIRJCU1-POEKIT | FLIR JCU1 POE INJECTOR KIT FOR FLIR M300 SERIES CAMERAS. INCLUDES: (1) FLIR T70477 JCU1 POE INJECTOR KIT CONSISTING OF: (1) JOYSTICK CONTROL UNIT (JCU 1) WITH WEATHER COVER, (1) 25' AND (1) 1' SHIELDED ETHERNET CABLE (RJ-45), (1) POWER OVER ETHERNET INJECTOR, (1) WATERPROOF COUPLER AND MOUNTING HARDWARE. | 1 | \$1,501.94 | \$1,501.94 |
| 23 | LESWL31B | (2) WHELEN L31 LOW PROFILE LED LAW ENFORCEMENT STROBES, BLUE. (2) WHELEN L31 LOW PROFILE LED LAW ENFORCEMENT STROBES, BLUE. MOUNTED ON RADAR POD FOR MAXIMUM 360DEG VISIBILITY. INCLUDES NECESSARY HARDWARE AND INSTALLATION. mounted to aft arch per rendering. | 1 | \$1,219.09 | \$1,219.09 |
| 24 | HPW112/SA315/W PA3 | WHELEN LOUDHAILER SYSTEM. WPA112, WPA3, SA315. WHELEN 100WATT LOUDHAILER SYSTEM. INCLUDES WPA112 AMPLIFIER, WPA3 CONTROL HEAD W/ HEAD PHONE JACK, FLUSH MOUNT KIT AND SA315 SPEAKER. INCLUDES NECESSARY HARDWARE AND INSTALLATION. | 1 | \$2,188.83 | \$2,188.83 |
| 25 | SLRCL-100LED | ACR RCL-100 LED REMOTE CONTROL SEARCHLIGHT, 220,000 CD, 12/24VDC. ACR RCL-100 LED REMOTE CONTROL SEARCHLIGHT, 220,000 CD, 12/24VDC. INCLUDES: (1) ACR P/N 1951 RCL-100 LED REMOTE CONTROL SEARCHLIGHT WITH (1) MASTER CONTROLLER, (1) WIRED POINT PAD, NECESSARY HARDWARE AND INSTALLATION. | 1 | \$2,080.36 | \$2,080.36 |
| 26 | FLDRLED-4-200-C | ADD (4) FORWARD FACING DR. LED "KEVIN" FLOOD LIGHTS TO SAFE CC. INCLUDES: (4) DR. LED "KEVIN" 8001344 600+ LUMENS LED FLOOD LIGHTS W/ STAINLESS STEEL BRACKETS, DEDICATED ON/OFF SWITCH LOCATED IN OVERHEAD SWITCH PANEL, NECESSARY HARDWARE AND INSTALLATION. | 1 | \$1,267.03 | \$1,267.03 |

12/01/23 11:04:58

4 of 6

| Line | Code | Description | Qty | Price | Ext. Price |
|------|----------------|--|-----|------------|------------|
| 27 | CFE-RADIO-1 | <p>INSTALL CUSTOMER SUPPLIED AGENCY RADIO & ANTENNA. RADIO MAKE/MODEL TBD. INCLUDES: POWER FROM 12VDC DISTRIBUTION PANEL TO RADIO MOUNTING LOCATION, NECESSARY HARDWARE AND INSTALLATION OF (1) CUSTOMER SUPPLIED RADIO AND ANTENNA.</p> <p>AGENCY RADIO COMPONENTS NOT TO EXCEED (1) RADIO HEAD WITH MIC, (1) RADIO BODY OR AMP (IF SEPARATE FROM RADIO HEAD), (1) EXTERNAL RADIO SPEAKER, AND (1) ANTENNA WITH MOUNT.</p> <p>DOES NOT INCLUDE: RADIO, DASH TO REMOTE MOUNT CONVERSION KIT, FLUSH MOUNT KIT, ANTENNA, MIC, EXTERNAL VHF SPEAKER OR ANY REQUIRED RADIO HARNESSSES.</p> | 1 | \$623.85 | \$623.85 |
| 28 | CPGVHF215AIS/S | <p>GARMIN VHF 215 AIS MARINE RADIO W/ SHAKESPEARE 5' VHF ANTENNA. INCLUDES: (1) GARMIN 010-02098-00 VHF 215 AIS MARINE RADIO WITH CLASS D DIGITAL SELECTIVE CALLING (DSC), 25 WATT TX POWER, AND BUILT IN AIS CAPABLE OF DISPLAYING AIS ON COMPATIBLE CHART PLOTTERS, (REQUIRES GPS INPUT VIA NMEA 0183/2000), (1) SHAKESPEARE 5' VHF ANTENNA WITH S/S RATCHET MOUNT, FLUSH MOUNT KIT, EXTERNAL VHF SPEAKER, NECESSARY HARDWARE AND INSTALLATION.</p> | 2 | \$1,340.58 | \$2,681.16 |
| 29 | GLTT | <p>(2) SBI UNIVERSAL GUN LOCKS INSTALLED IN T-TOP BOLSTER. INCLUDES: (2) SBI UNIVERSAL GUN LOCKS MOUNTED IN T-TOP BOLSTER, NECESSARY HARDWARE AND INSTALLATION.</p> | 1 | \$480.73 | \$480.73 |
| 30 | TOW150 | <p>TOW SPOOL W/ 150 LINE & COVER. TOW LINE STORAGE SPOOL MOUNTED ON AFT SIDE OF RADAR POD. TOW SPOOL WILL STORE 150' OF 3/4 DBN TOW LINE. INCLUDES TOW SPOOL COVER, 150' OF LINE, NECESSARY HARDWARE AND INSTALLATION.</p> | 1 | \$2,308.56 | \$2,308.56 |
| 31 | SFTYKT | <p>Mounted below tow post per rendering. OFFSHORE SAFETY KIT SAFETY KIT. KIT INCLUDES: 24" LIFE RING BUOY WITH DISTRESS MARKER LIGHT, PORTABLE BILGE PUMP, 10-PERSON FIRST AID KIT, OFFSHORE MARINE FLARE SIGNAL KIT AND HAND HELD COMPRESSED AIR HORN.</p> | 1 | \$959.29 | \$959.29 |
| 32 | DK17-38 | <p>DOCKING KIT FOR 17-38 HULLS. DOCKING KIT FOR 17'-38' HULLS. KIT INCLUDES: FOUR(4) 30' X 5/8" DBN DOCK LINES W/ EYE SPLICE AT ONE END (BLACK), FOUR(4) 5.5" X 20" 2-EYED RIBBED BLACK FENDERS, AND FOUR(4) 3/8" X 9' FENDER WHIPS (BLACK).</p> | 1 | \$523.55 | \$523.55 |
| 33 | AK17-25 | <p>ANCHOR KIT 17-25 ANCHOR KIT FOR 17'-25' HULLS. KIT INCLUDES: (1) FORTRESS FX7 4LB ANCHOR, (2) 3/8" S/S SHACKLE, (9 FT) S/S ANCHOR CHAIN, (1) 3/8" S/S EYE-TO-JAW SWIVEL, AND (150') 5/8" 3 STRAND W/ S/S THIMBLE.</p> | 1 | \$710.18 | \$710.18 |
| 34 | 2DFT-LOC | <p>2-DAY FAMILIARIZATION TRAINING, AT CUSTOMER LOCATION. CONUS,AK,HI 2-DAY FAMILIARIZATION TRAINING: THIS INTRODUCTORY BOAT OPERATIONS COURSE WILL PROVIDE THE CUSTOMER WITH A BASIC UNDERSTANDING OF THEIR NEW SAFE BOAT, ITS SYSTEMS, AND THE RELEVANT OPERATIONAL CHARACTERISTICS; 1 INSTRUCTOR FOR UP TO 10 STUDENTS.</p> <p>INCLUDES: -INSTRUCTOR(S) -INSTRUCTOR TRAVEL (AIRFARE, HOTEL, MEALS, ETC.)</p> <p>NOT INCLUDED: -BOAT OPERATIONAL COSTS (LAUNCHING, MOORING, FUEL, ETC.) -OEM INSTRUCTORS (CAN BE ADDED FOR AN ADDITIONAL FEE) -SALES TAX (IF REQUIRED)</p> | 1 | \$3,500.00 | \$3,500.00 |

12/01/23 11:04:58

5 of 6

| Line | Code | Description | Qty | Price | Ext. Price |
|------|----------|--|-----|--------------|--------------|
| 35 | TRL3 | TRAILER, 7150 - 25' T-TOPS/CC (8'6" ONLY), GALVANIZED TRAILER 7150 - 25' T-TOPS & CENTER CONSOLES (8'6" OR 102 INCHES ONLY) GALVANIZED BUNK TRAILER WITH DISC BRAKES, BOW LADDER, V-STOP AND LED LIGHTING. | 1 | \$13,440.64 | \$13,440.64 |
| 36 | Prep3 | SHIPPING PREP/FULL SHRINK WRAP PREPARATION FOR SHIPPING INCLUDES: 1 DISCONNECT BATTERIES FROM ELECTRICAL SYSTEM. 2 SECURE LOOSE GEAR TO PREVENT SHIFTING DURING SHIPMENT. 3 SECURE BOAT TO TRAILERS. (IF APPLICABLE) 4 SECURE EQUIPMENT (E.G., MOTORS, SPOTLIGHT, ETC.) AS NECESSARY TO PREVENT MOVEMENT DURING SHIPMENT. 5 REMOVE FLAMMABLE LIQUIDS IF REQUIRED TO COMPLY WITH OCEAN TRANSPORTATION REQUIREMENTS. 6 PLACE RADOME AND ANTENNAS IN LOWERED POSITION. 7 ENSURE NO MORE THAN 10 GALLONS FUEL REMAINS IN THE FUEL TANKS. 8 PLACE BOAT CABIN KEY IN A SECURE "HIDE" 9 PROTECTIVE SHRINK WRAP (COVERS BOAT DOWN TO COLLAR AND OUTBOARD ENGINES IF APPLICABLE) DOES NOT INCLUDE ACTUAL TRANSPORTATION CHARGES | 1 | \$2,348.48 | \$2,348.48 |
| 37 | DISCOUNT | CUSTOMER DISCOUNT | 1 | -\$27,792.34 | -\$27,792.34 |

Payment Terms:

- 40% - Upon receipt of order
- 30% - Upon completion of welding
- 30% - Upon final vessel acceptance

Shipping - Vessel shipping price includes shipment of the vessel (and trailer, if ordered along with vessel) from Bremerton, WA to customer's location (exact location TBD). Vessel will be shipped on a low-boy trailer. Customer is responsible for arranging offload of the vessel (and trailer, if applicable) from the low-boy trailer, typically performed with a marine travel lift or crane service. The vessel cannot be launched directly from the low-boy to the water.

| | |
|-----------------|---------------------|
| SubTotal | \$333,351.02 |
| Tax | \$0.00 |
| Shipping | \$11,596.00 |
| Total | \$344,947.02 |



Memorandum

APPROVED: 
Jennifer S. Tooker
First Selectwoman
Date: ___/___/___

To: Honorable Jen Tooker, First Selectwoman
CC: Gary Conrad, Finance Director; Foti Koskinas, Chief of Police
From: Deputy Chief Ryan Paulsson
Date: November 17, 2023
Re: Request for new Motors for Marine I police patrol boat (Updated 11/28/2023)

The Westport Police Department is requesting funds to replace the current motors for the Marine I police patrol boat.

Marine I, a 33-foot 2014 NAID, is the primary all-weather, all-season boat for the Westport Police Department and responds to all major incidents. The boat has a cabin to store public safety equipment, protect responding officers, and to treat victims in poor weather-related occurrences. In addition, Marine I is the dive platform for all dive-rescue related incidents along the shoreline on a year-round basis. Marine I remains in the water throughout the winter in mission-ready status to respond to marine-related calls for service, especially for commercial marine activities which occur in Westport waters.

The current motors for Marine I have reached almost 800 hours and would need replacement at the end of the 2024 season. It is anticipated based upon current manufacturing timelines, that the new motors will take 60 weeks to be procured and should be in place for the 2025 season.

The proposed replacement costs include:

- Labor - Removal of current motors and derigging of all harnesses, wiring, and gauges. Installation of new motors and all necessary rigging.
- 2 – Mercury 350 v10 outboard motors
- 2 sets of rigging packages
- Water testing
- GSA pricing

The Police Department therefore respectfully requests an appropriation in the amount of \$85,840.00 for the replacement of the two existing motors for the Marine I police patrol boat.

Bill Landans Marine Service LLC
 21 Matilda Lane
 Shelton,Ct.06484
 Tel: 203 831-8833 Fax: 203 899-9849
 E-Mail: L and R Marine@gmail.com

Invoice/Est.

| Date | Invoice # |
|------------|-----------|
| 11/14/2023 | 3401 |

| Name / Address |
|---|
| Westport Police Dept Marine Unit Westport ,Ct.06880 |

| Description | Qty | Rate | Terms |
|---|-----|--------------|--------------------|
| | | | Due Upon Receipt |
| Description | Qty | Rate | Total |
| Labor-remove evenrudes and all rigging-install new mercury rigging and new 4 stroke engines | 62 | 180.00 | 11,160.00 |
| 2 mercury v-10 -government pricing | 2 | 30,000.00 | 60,000.00 |
| 2 rigging packages | | 14,500.00 | 14,500.00 |
| Water Test | | 180.00 | 180.00 |
| Sales Tax | | 6.35% | 0.00 |
| Thank you for your business. | | Total | \$85,840.00 |

| Phone # |
|--------------|
| 203-247-4822 |

Thursday December 21, 2023

JOINT REPORT FROM RTM PUBLIC PROTECTION AND FINANCE COMMITTEES

The RTM Finance and Public Protection Committees meet in a joint meeting with members of the Westport Police Department via Zoom on Tuesday December 19th, 2023, to discuss and vote to recommend to the full RTM on the following Board of Finance approvals:

1. Upon the request of the Deputy Chief of Police, to approve an appropriation of \$362,194.37 from the Capital and Non -Recurring Fund Account 31502210-500212-22101 for the replacement of the existing 2006 Boston Whaler "Marine ii" police patrol boat.
2. Upon the request of the Deputy Chief of Police, to approve an appropriation of \$85.840 from the same Capital and No-Recurring Fund as appropriation item 1 for the replacement of the two existing motors for the "Marine I" police patrol boat.

Deputy Chief Ryan Paulson and Chief Foti Koskinas made a short presentation on how the Marine ii have given the town 16 years of service, 6 years past lifetime. They explained to committees how the Marine Division and Dive Teams work with other Marine Divisions and the importance of having safe and proper equipped boats for our water ways and Long Island Sound.

After a brief question and answer period on cost of maintenance, how the boats are used, etc. The motion was made to vote – Public Protection Sal Liccione Second Karen Kramer. Finance Nancy Kail Second Don O'day.

Both Committees voted unanimously 7-0 and 7-0 to recommend approval of appropriation to full RTM

Appropriation 2 – Deputy Chief Paulson made a short presentation on the need for new outboard motors for Marine -I. RFPs went out, and the best price and fit for Marine -! Mercury ended the overall best price and value at \$85.840 for the motors.

After a short Question and Answer – The motion was made to go to a vote. Public Protection – Andy Colabella – Second Candace Banks. Finance Motion Don O'day – Second Ari Benmosche

Both Committees voted unanimously 7-0 and 7-0 to recommend approval of appropriation to full RTM.

Attendance – Police Chief Fotis Koskinas, Deputy Police Chief Ryan Paulson.

Public Protection – Jimmy Izzo Chair, Louis Mall, Sal Liccione, Andrew Colabella, Candace Banks, Dick Lowenstein, and Claudia Shaum

Finance – Seth Bruanstein Chair, Ari Benmosche, Rachel Cohn, Lyn Hogan, Nancy Kail, Don O’Day, and Michael Perry.

Respectfully Submitted,

Jimmy Izzo Chair – Public Protection

Seth Braunstein Chair- Finance



WESTPORT, CONNECTICUT

DEPARTMENT OF PUBLIC WORKS
TOWN HALL, 110 MYRTLE AVE.
WESTPORT, CONNECTICUT 06880
(203) 341 1120

November 17, 2023

Jennifer S. Tooker
First Selectwoman
Town Hall
Westport, CT 06880

Re: Request for Appropriation from the Capital and Non-recurring fund – Purchase of one (1) F350 Building Maintenance Service Truck with Service body and lift gate

Dear Ms. Tooker,

This office respectfully requests an appropriation of **\$65,000** for replacement of our 2013 F350 Building Maintenance Service Truck. This is a front-line piece of equipment assigned to the Division. On a daily basis it is used for servicing our buildings and Facilities. The truck is also one of three vehicles that Building Maintenance uses to clear and manage snow and ice removal for our public buildings and facilities during snowstorms. During other severe weather events such as Nor'easters, Hurricanes, severe windstorms, etc., this vehicle is one of several that we use to move portable generators and other equipment around town to locations that need them.

Currently Truck #53 is showing signs of fatigue and wear. We anticipate needing numerous other repairs to the to the vehicle in coming years. In the current used truck environment, and based on recent sales, we anticipate getting a good price for the vehicle at auction, which will be used to offset the cost of the new vehicle.

This truck is scheduled for replacement on the 10-year Capital forecast in FY 2024 at a value of \$65,000. The attached cost summary reflects the base price for the vehicle from State Bid #19PSX0161, the upfit of the cab and chassis with a utility body and lift gate, for a total of \$67,068.90. Utilizing a and a 12% allowance for installation of lights, radio, electronics, and other accessories, the request is for a grand total of **\$75,000**.

Respectfully,

A handwritten signature in black ink, appearing to read "Peter A. Ratkiewich".

Peter A. Ratkiewich, P.E.
Director of Public Works
cc: Gary Conrad, Finance Director

FISCAL YEAR 2024

TOWN OF WESTPORT, CT

JUSTIFICATION FOR A EQUIPMENT/VEHICLE

DEPARTMENT INFORMATION

| | | |
|-------------------|------------------------------------|-----------------------|
| DEPT NAME: | PUBLIC WORKS – FACILTY MAINTENANCE | Date: 11/17/23 |
|-------------------|------------------------------------|-----------------------|

| |
|---|
| EQUIPMENT OR VEHICLE NAME AND DESCRIPTION REPLACEMENT FOR 2013 F350 W/ LIFTGATE |
|---|

| | | | |
|---|---|---------------------------------------|--|
| IS IT LISTED IN THE 5-YR CAPITAL FORECAST? | YES <input checked="" type="checkbox"/> | NO <input type="checkbox"/> | |
| If no, why not? | | | |

| | | | |
|--------------------------|----------|----------------------------------|----------|
| APPROXIMATE COST: | \$75,000 | COST IN CAPITAL FORECAST: | \$65,000 |
| Source of funds: | | CNR – PUBLIC WORKS | |

| | |
|-------------------------------|-----------------|
| ESTIMATED USEFUL LIFE: | 10 YEARS |
|-------------------------------|-----------------|

| | | | |
|---------------------------------------|--|--|--|
| Has an RFP been issued? | YES <input type="checkbox"/> | NO <input checked="" type="checkbox"/> | This vehicle cost is based on the State bid #19PSX0161 |
| Have bids been received? | YES <input type="checkbox"/> | NO <input checked="" type="checkbox"/> | Number of bids received: _____ |
| Was the lowest bid the winner? | YES <input type="checkbox"/> | NO <input type="checkbox"/> | If not, why? |

| |
|--|
| How will the equipment/vehicle be used? This vehicle is used in daily operations by the Building Maintenance division to move men materials and equipment between various town properties. During storms it is used heavily to shuttle snow blowers, salt and tools around to various town properties for snow removal |
|--|

| | | | |
|--|---|--|-----------------------|
| Is it a replacement? | YES <input checked="" type="checkbox"/> | NO <input type="checkbox"/> | 2013 F350 w/Lift Gate |
| If yes, describe condition of what is to be replaced: _____ Please see spreadsheet | | | |
| Pictures attached? | YES <input type="checkbox"/> | NO <input checked="" type="checkbox"/> | |

G:\PW_OFF\PARVAPPRQST\CPR-F350_LIFTGATE_BM53.DOCX

FINANCE

This section to be completed by the Finance Director.

EFFECT ON TOWN FINANCES, INCLUDING DEBT SERVICE:

IF APPROVED:

IF NOT APPROVED:

REVIEW/SIGN-OFF

DEPARTMENT HEAD



DATE: 11/17/23

FINANCE DIRECTOR

DATE:

FIRST SELECTMAN



DATE: 11-21-2023

G:\PW_OFF\PARVAPPRQSTICPR-F350_LIFTGATE_BM53.DOCX

SUMMARY OF TRUCK # 62 REPLACEMENT COST:

| | |
|--|---------------------|
| Base Price from State Bid # 19PSX0161 | \$ 46,055.00 |
| Total Options including discount | \$ 1,903.50 |
| Truckcraft upfit costs, including discount | \$ 19,110.40 |
| Total cost from dealer | \$ 67,068.90 |

| | |
|--|-------------|
| Allowance for Strobes, AVL + installation, seat covers, Radio + installation, on-board tablet, etc.; (estimate at 12% dealer cost) | \$ 8,048.27 |
|--|-------------|

| | |
|-------------|--------------|
| Grand total | \$ 75,117.17 |
|-------------|--------------|

| | |
|------------------------------|---------------------|
| Appropriation Request | \$ 75,000.00 |
|------------------------------|---------------------|

Prepared by :
 Peter Ratkewich, P.E.
 Westport Director of Public Works

Gengras Ford, LLC

225 New Britain Avenue
Plainville, CT 06062
Phone: 860.727.6302
www.gengras.com



Quote Number: 230922009

Fleet Nr:

STATE CONTRACT NO: 19PSX0161

| Make | MY | Model | Contract Price |
|------|------|---|----------------|
| Ford | 2024 | F-350 Reg Cab 4x4 (F3B) - 142" WB, 8 foot bed | \$ 46,055.00 |



All specifications are subject to verification of manufacturer's published standard and optional equipment. Vehicle to include all manufacturer's standard equipment plus the following options:

| | Option Code | Description | List Price |
|--|-------------|--|-------------|
| 1 | Z1 | Oxford White | \$ - |
| 2 | A5 | Vinyl 40/20/40 Medium Dark Slate | \$ - |
| 3 | 99A | 6.8L DEV V8 Gas engine | \$ - |
| 4 | 44F | Ten speed Automatic Trans | \$ - |
| 5 | 610A | XL Package | \$ - |
| 6 | STD | Cruise Control | \$ - |
| 7 | STD | Trailer Brake Controller (Incl. Smart Trailer Tow Connector) | \$ - |
| 8 | STD | Power Equipment Group - Manually Telescoping, Folding Trailer Tow Mirrors with Power/Heated Glass, Heated Convex Spotter Mirror, Integrated Clearance Lamps/Turn Signals | \$ - |
| 9 | STD | Spare Key - One (1) | \$ - |
| 10 | 473 | Snow Plow Prep | \$ 250.00 |
| 11 | 67B | HD Alternator - 410 amp | \$ 115.00 |
| 12 | 86M | Medium-duty Batteries | \$ 210.00 |
| 13 | 66S | Upfitter Switches | \$ 165.00 |
| 14 | 43C | 110 v / 400 watt Inverter | \$ 175.00 |
| 15 | 592 | Roof Clearance Lights | \$ 95.00 |
| 16 | 18B | Cab Steps | \$ 320.00 |
| 17 | X9E | 3.73:1 Locking Rear Axle | \$ 430.00 |
| 18 | TDX | AT Tires - 18" | \$ 265.00 |
| 19 | GVW | 11,400 lb GVWR | \$ - |
| 20 | | | \$ - |
| 21 | | | \$ - |
| 22 | | | \$ - |
| 23 | | | \$ - |
| 24 | | | \$ - |
| 25 | | | \$ - |
| Total Options per Contract Price (list price) | | | \$ 2,025.00 |
| Total Factory Options Discount (6%) | | | \$ (121.50) |
| Total Options per Contract Price (net price) | | | \$ 1,903.50 |

Gordon Rapp
Fleet municipal Sales

2024 Ford F-350 w Service Body

9/22/2023

| Gengras Ford, LLC | | Page 2 | |
|--|-----------------------|---|---|
| 225 New Britain Avenue Plainville, CT 06062 Phone: 860.727.6302 www.gengras.com | |   | |
| | | | Quote Number: 230922009 |
| Aftermarket Accessories | | | |
| # | Vendor / Manufacturer | Hours | Description |
| 1 | Reading Body | 2.0 | Eight foot service body and accessories as described on the following page |
| 2 | Other | 2.0 | Complete chassis and underbody rustproofing |
| 3 | | 0.0 | |
| 4 | | 0.0 | |
| 5 | | 0.0 | |
| 6 | | 0.0 | |
| Total Hours | | 4.0 | |
| | | | <i>Total Aftermarket Options (list price)</i> \$ 23,238.00 |
| | | | <i>Total Aftermarket Options Discount (20%)</i> \$ (4,647.60) |
| | | | <i>Total Hours x \$130 / hour rate</i> \$ 520.00 |
| | | | Total Net Aftermarket Options plus Total Labor \$ 19,110.40 |
| Trade Allowance | | | |
| Year | Make | VIN | Description / Mileage |
| | | | |
| | | | |
| | | | |
| | | | |
| | | | Total Trade In Allowance \$ - |
| Comments: | | | |
| Ballment pool pick up truck stock order placed by Gengras Ford. Chassis upfit is required before pool release to dealer. | | | |
| Additional fees / Charges | | | |
| | | | State of CT Trade In Assessment (Note: Fee is payable to State of CT): \$ - |
| | | | Dealer Conveyance Fee (\$799.00) \$ - |
| | | | Registration Fee (estimated, actual cost will appear on your final invoice) \$ - |
| | | | DMV Inspection Fee (as required) \$ - |
| | | | Total Additional Fees \$ - |
| Customer: | Town of Westport | | |
| FIN Code: | QD236 | | |
| VIN: | | | |
| | | | Total (per unit) \$ 67,068.90 |
| Quantity | 1 | | Grand Total (all) \$ 67,068.90 |
| This quote valid for 30 days from the date created. | | | |

Gordon Rapp
Fleet municipal Sales

2024 Ford F-350 w Service Body

9/22/2023



WESTPORT, CONNECTICUT

DEPARTMENT OF PUBLIC WORKS
TOWN HALL, 110 MYRTLE AVE.
WESTPORT, CONNECTICUT 06880
(203) 341 1120

November 20, 2023

Mr. Jennifer S. Tooker
First Selectwoman
Town Hall
Westport, CT 06880

Re: Request for Appropriation from American Rescue Plan Act, (ARPA), Funds for additional Post Road Bus shelters

Dear Ms. Tooker,

This office herein requests an appropriation from the American Rescue Plan Act Funds in the amount of **\$250,000.00** for the construction of four bus shelters at various locations along the Post Road

In December of 2021 the RTM appropriated \$150,000 for construction of four bus shelters along the Post Road. At present two of those structures are being constructed with two more going in shortly after. However, the material cost for the shelters themselves has risen significantly since 2021. Attached is a cost estimate per shelter.

The work will be bid out utilizing our normal purchasing procedure and we anticipate doing the construction over this coming summer and the next.

Respectfully,

A handwritten signature in black ink, appearing to read "Peter A. Ratkiewich", is written over a horizontal line.

Peter A. Ratkiewich, P.E
Director of Public Works

cc: Gary Conrad, Finance Director
G:\PW_OFF\PAR\APPRQST\ARPA BUSSHELTERS R2.DOCX

FISCAL YEAR 2023

TOWN OF WESTPORT, CT

JUSTIFICATION FOR A CAPITAL PROJECT

DEPARTMENT INFORMATION

DEPT NAME: Department of Public Works Date: 11-20-23

PROJECT NAME AND DESCRIPTION
Construction of four bus shelters along the Post Road

IS IT LISTED IN THE 5-YR CAPITAL FORECAST? YES NO
 If no, why not?
 If yes, answer the following two questions:
 Which FY was the project first proposed? 2023
 Which FY was the project first planned? 2021

| | | | |
|--------------------|--------------|---------------------------|---------------------|
| APPROXIMATE COST: | \$226,000.00 | COST IN CAPITAL FORECAST: | |
| CONTINGENCY (10%): | \$ 22,600.00 | | |
| | \$248,600.00 | ← TOTAL | REQUEST → \$250,000 |

SOURCE OF FUNDS:

| | |
|---------------------------------------|---|
| CAPITAL BOND <input type="checkbox"/> | GEN'L FUND <input type="checkbox"/> |
| CNR <input type="checkbox"/> | GRANT <input type="checkbox"/> |
| STATE <input type="checkbox"/> | OTHER <input checked="" type="checkbox"/> |

OTHER, DESCRIBE: ARPA funds

PAYBACK PERIOD: N/A

PROJECTED START DATE: Summer 2024 EST. COMPLETION DATE: Fall 2024
 ESTIMATED USEFUL LIFE: 30 years

Is this project part of a larger capital project?

Has an RFP been issued? YES NO Project will be bid using our normal purchasing procedure

Have bids been received? YES NO Number of bids received: _____

Was the lowest bid the winner? YES NO If not, why? _____

Who will benefit from the project?
Users of the Coastal link transit system

G:\Pw_off\PARVAPPRQST\CPR-BusSheltersR2.docx

Is it a replacement? YES NO

If yes, describe condition of what is to be replaced: _____

Pictures attached? YES NO

What other approvals/reviews are necessary to begin this project? RTM, BOS

FINANCE

This section to be completed by the Finance Director.

EFFECT ON TOWN FINANCES, INCLUDING DEBT SERVICE:
IF APPROVED:
IF NOT APPROVED:

REVIEW/SIGN-OFF

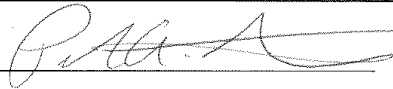
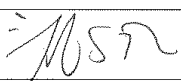
| | | |
|------------------|---|------------------|
| DEPARTMENT HEAD |  | DATE: 11-20-23 |
| FINANCE DIRECTOR | _____ | DATE: _____ |
| FIRST SELECTMAN |  | DATE: 11-21-2023 |

G:\Pw_of\PAR\APPRQST\CPR-BusSheltersR2.docx

Bus shelter Estimate

| | | | |
|------------------------|---------------|-------------------|--|
| Estimated Shelter cost | \$ 40,000.00 | | |
| solar lighting | \$ 2,500.00 | | |
| concrete pad | \$ 8,000.00 | | |
| sidewalk allowance | \$ 6,000.00 | | |
| subtotal | \$ 56,500.00 | | |
| 10% contingency | \$ 5,650.00 | | |
| Grand total | \$ 62,150.00 | per shelter | |
| | | | |
| | \$ 248,600.00 | for four shelters | |



Engineer's Cost Estimate
Pump Station #10 - 10" DIP Force Main CIPP Lining Phase 3 (formerly phase 2)
1720 Post Road East - 1620 Post Road East

| Item | Item Description | Estimated Cost | Vendor | Actual Costs |
|------|--|----------------|---------------------------|--------------|
| 1 | 1000' LF - 10" CIPP Liner Complete in Place \$146.00 / LF | \$ 146,000.00 | Green Mountain (Proposal) | |
| 2 | Bypass Trucking of sewage 3-trucks, 3 days, 10hrs/day = 90 hours @ \$300.00/hr | \$ 27,000.00 | Estimated | |
| 3 | Support Excavation & Pipe Work | \$ 75,000.00 | A.J Penna (Proposal) | |
| | 1) Entry Pit 16' L x 6" w x 10' d Excavate & Shore (2-5 day duration) | | | |
| | Cut & Remove 2 - 45deg bends and cut back 10" DIP 8' - 10' separation to open ends | | | |
| | Install new 10" C900 with 2-10" DIP 45deg bends with MJ fittings & 2 10" Hymax couplings | | | |
| | Restore all affected concrete sidewalks and driveway apron and pavement restoration | | | |

Total Estimated \$ 248,000.00
 10% Contingency \$ 24,800.00
Grand Estimated Total \$ 272,800.00

Funding Request \$ 275,000.00



DEPARTMENT OF PUBLIC WORKS

TOWN HALL, 110 MYRTLE AVE.
WESTPORT, CONNECTICUT 06880
(203) 341 1120

November 17, 2023

Jennifer S. Tooker
First Selectwoman
Town Hall
Westport, CT 06880

Re: Appropriation from Sewer Reserve Fund
Emergency Repairs to Force Main, PS#10, Round 3

Dear Ms. Tooker,

This office, herein, requests an appropriation from the Sewer Reserve Fund in the amount of Two Hundred Seventy Five Thousand dollars (\$275,000.00) for the third round of emergency repairs to the Pump Station #10 force main. I am referring to this last repair effort as Round 3.

Pump Station #10 is located on the north side of Greens Farms Road, at the town line between Westport and Fairfield. It was constructed in 1975 along with a 10" ductile iron force main. The force main runs from the pump station westerly along Greens Farms Road, northerly up Bulkley Avenue South, then across the Stop and Shop parking lot exiting at the western entrance to Stop and Shop. From there it runs west along the Post Road until discharging in a gravity manhole just East of Maple Avenue.

In August of this year, we were called out to repair new ruptures in the existing ductile iron line, in a location west of our 2022 Round 1 repair, once again on an emergency basis. In August we requested and received \$275,000 to line an additional 1000 LF of pipe, one end of which ran under the 345KW electrical duct bank the runs along the Post Road. (I will refer to that request as Round 2 of the lining repair project). During the attempt at execution of Round 2, we ran into some undocumented bends in the force main that prevented us from installing the liner in the intended Round 2 pipe run. In order to prevent just shutting down the effort, and incurring mobilization costs, our crew quickly shifted gears and lined the remaining 1000 feet further west of the entry point.

At the same time, we analyzed the issue on the undocumented pipe bends and determined what we would need to do to get the line through the original intended sewer run. We still had to line that section as it was the section most at risk of creating a major problem. Last week we were

Pump Station #10 Force Main Emergency Repair request ; November 17, 2023

able to get the liner through the last 1000 feet of pipe, under the electrical duct bank, and complete the 3000 LF of pipe lining. This \$275,000 request is to cover the last 1000 feet that we completed last week.

All three Rounds of Pipe lining were part of a larger project to replace the entire force main, which was projected in the 5-year capital forecast in FY2024 at a cost of \$750,000. Because of the recent breaks this work was done on an emergency basis and will resolve the worst sections of the pipe run permanently without any major disruption to the retail establishments along the Post Road under which it runs.

Attached is a breakdown of costs associated with this work.

Respectfully,



Peter A. Ratkiewich
Director of Public Works

cc: Gary Conrad, finance Director

G:\Pw_of\PAR\APPRQST\PS#10 Force MainEmerRepairs Round3

FISCAL YEAR 2024

TOWN OF WESTPORT, CT

JUSTIFICATION FOR A CAPITAL PROJECT

DEPARTMENT INFORMATION

DEPT NAME: Department of Public Works November 17, 2023

PROJECT NAME AND DESCRIPTION
Pump Station 10 Force Main Pipe Lining Round 3

IS IT LISTED IN THE 5-YR CAPITAL FORECAST? YES NO

If no, why not? First Proposed in 2019
 If yes, answer the following two questions:
 Which FY was the project first proposed?
 Which FY was the project first planned? Planned for 2024 but has become an emergency repair due to additional ruptures.

\$750,000.00 for 3100lf of 10" force main. The current request will replace 1000lf or 1/3 the total length.

| | | | |
|--------------------|--------------|---------|------------------------|
| APPROXIMATE COST: | \$248,000.00 | | |
| CONTINGENCY (10%): | \$24,800.00 | | |
| | \$272,800.00 | ← TOTAL | REQUEST → \$275,000.00 |

SOURCE OF FUNDS:

| | |
|--|--|
| CAPITAL BOND <input type="checkbox"/> | GEN'L FUND <input type="checkbox"/> |
| CNR <input type="checkbox"/> | GRANT <input type="checkbox"/> |
| STATE <input type="checkbox"/> | OTHER <input checked="" type="checkbox"/> |

OTHER, DESCRIBE: Sewer Reserve Fund

PAYBACK PERIOD:

| | | |
|---|-----------------|--------------------------------|
| PROJECTED START DATE: <u>November 1, 2023</u> | EST. COMPLETION | DATE: <u>November 10, 2023</u> |
|---|-----------------|--------------------------------|

ESTIMATED USEFUL LIFE: 75 years

Is this project part of a larger capital project? yes

Has an RFP been issued? YES NO Engineering staff developed bid documents

Have bids been received? YES NO Number of bids received: 2 Prequalified Bidders

Was the lowest bid the winner? YES NO If not, why? _____

Who will benefit from the project? Residents within the associated sewer-shed

G:\PW_OFF\PAR\APPRQST\CPR-PS10-FM CIPP LINING ROUND 3.DOCX

[Empty rectangular box]

Is it a replacement? YES NO Internal lining of the existing force main with a "Cured in Place Pipe" CIPP Fiberglass reinforced liner

If yes, describe condition of what is to be replaced: _____

Pictures attached? YES NO

[Empty rectangular box]

What other approvals/reviews are necessary to begin this project? RTM, BOS
 (NOTE: This project is going ahead on an emergency basis, per approval from the Finance Director)

FINANCE



This section to be completed by the Finance Director.

EFFECT ON TOWN FINANCES, INCLUDING DEBT SERVICE:

IF APPROVED: _____

IF NOT APPROVED: _____

REVIEW/SIGN-OFF

| | | |
|------------------|---|------------------|
| DEPARTMENT HEAD |  | DATE: 11.20.23 |
| FINANCE DIRECTOR | _____ | DATE: _____ |
| FIRST SELECTMAN |  | DATE: 11-21-2023 |

G:\PW_OFF\PARVAPPRQST\CPR-PS10-FM CIPP LINING ROUND 3.DOCX

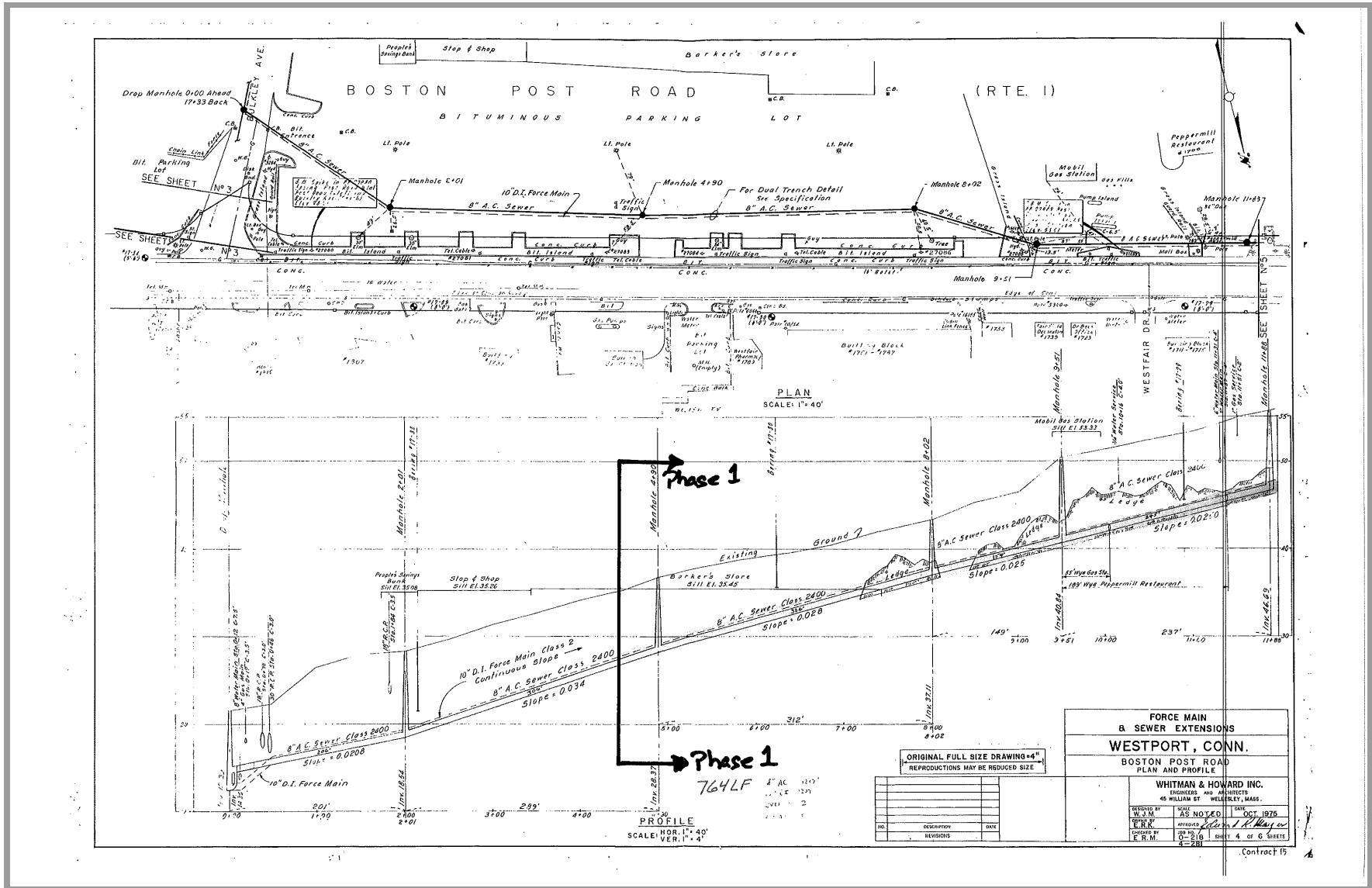

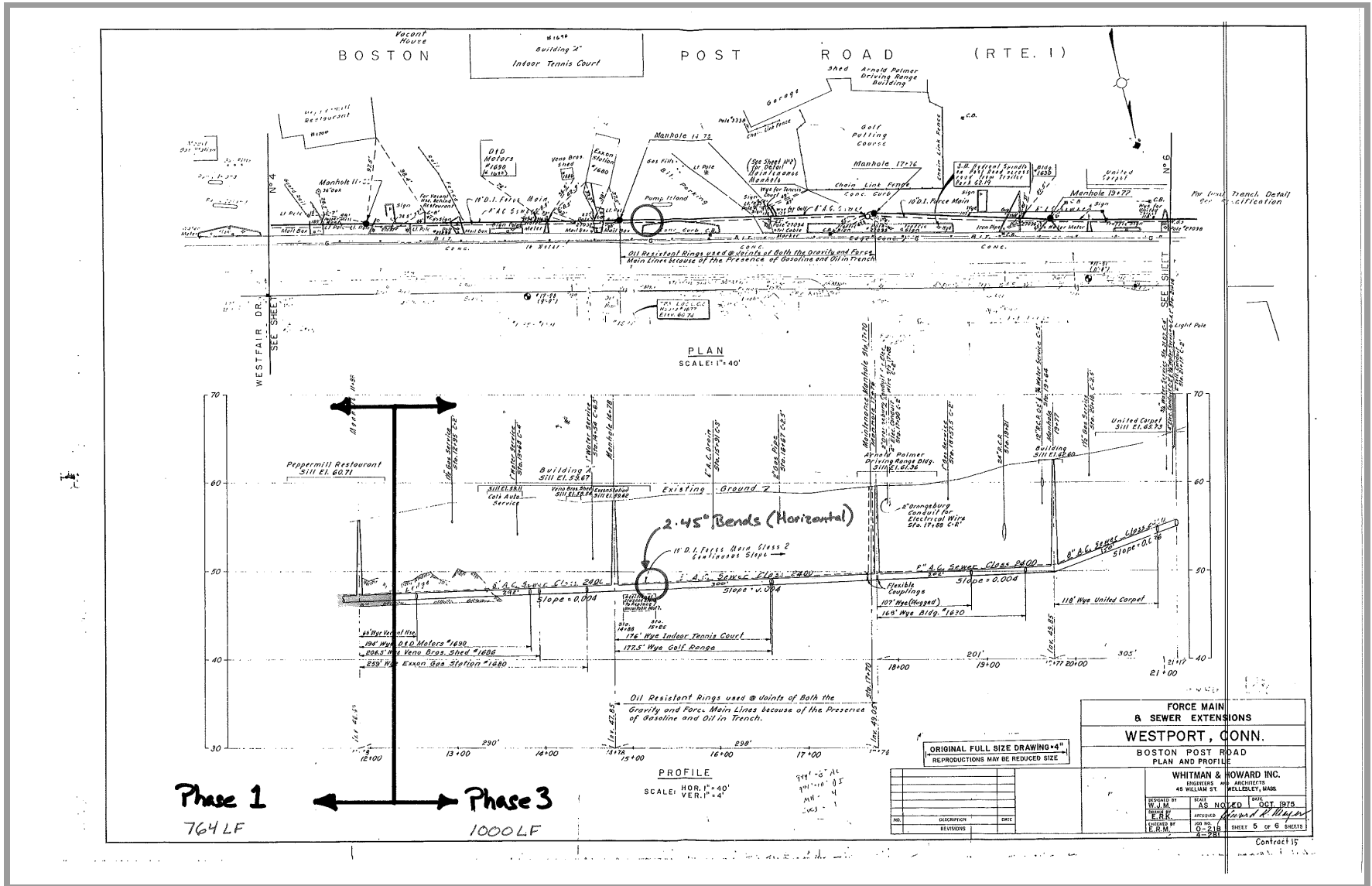

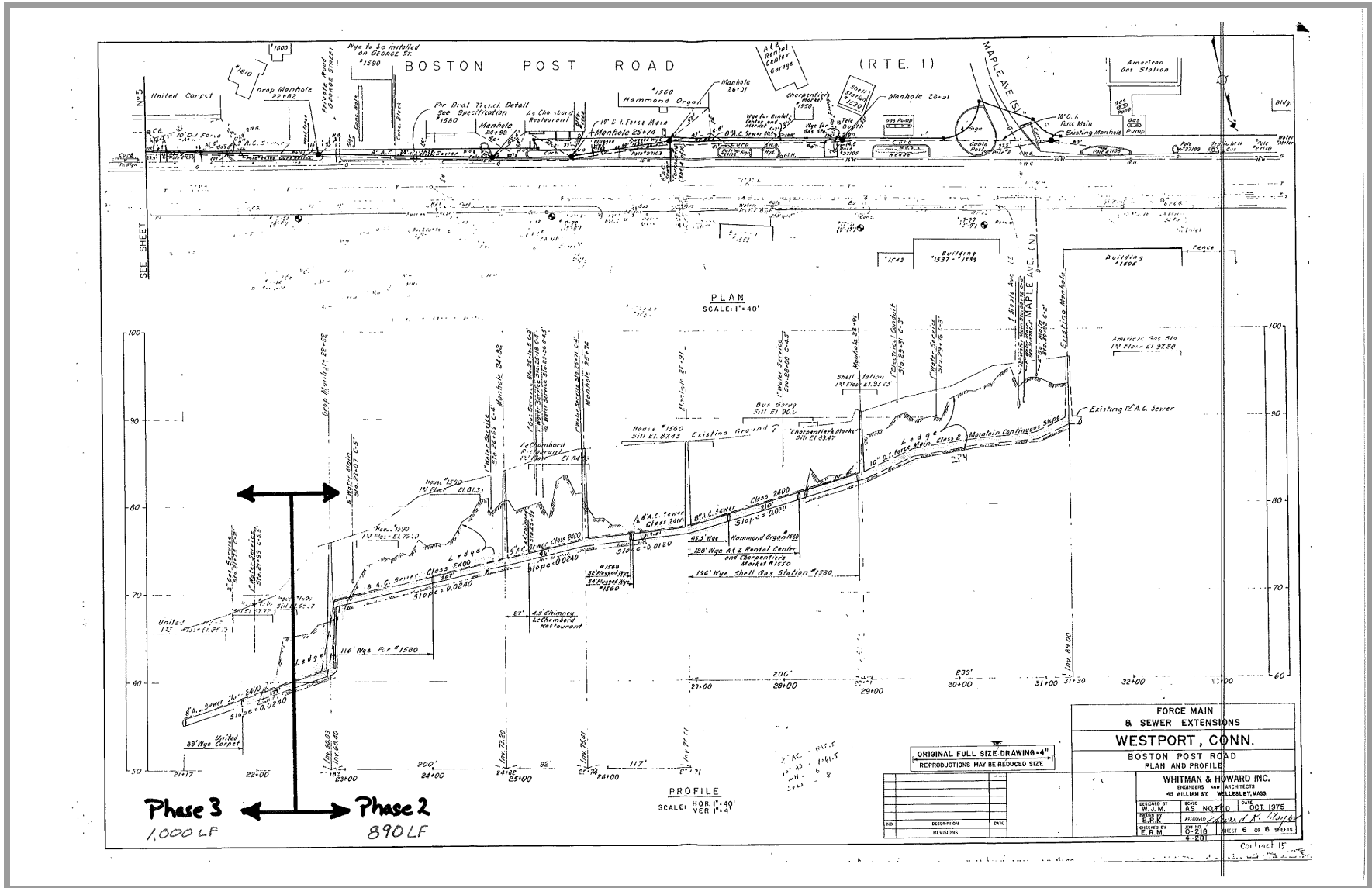

RTM PUBLIC WORKS & FINANCE COMMITTEE MEETING

DATE; PW, Finance & Transit – Tuesday, December 19, 2023

TIME; PW/Finance/Transit - 7:30 PM meeting start, via ZOOM

PURPOSE; Review requested Public Works Department expenditures for F350 Building Maintenance Truck, Bus Shelters, Pump Station #10 Force Main Repairs

PRESENTED BY; Peter Ratkiewich, Public Works Director

Building Maintenance Service Truck - Mr. Ratkiewich requested an appropriation of \$75,000.00 to the Capital and Non-Recurring Fund Account for the purchase of a new F350 Building Maintenance Truck to replace the current 2013 version. The current 2013 truck is showing signs of wear and tear and it is anticipated that numerous repairs will be required in the coming years. The truck is used for maintaining the Towns buildings and facilities, is used for snow and ice removal during storms as well as moving portable generators during storm conditions. The existing vehicle will be sold and the revenue from the sale will offset the cost of the vehicle. The vehicle is currently anticipated in the 2024 capital forecast in the amount of \$65,000. The truck will be purchased through the State Bid with the additional installation of lights, radios and other electronics. The committees asked several general questions and voted as follows; The Public Works Committee voted 6-0 to recommend and the Finance Committee voted 7-0 to recommend approval to the full RTM.

Bus Shelters - Mr. Ratkiewich requested an appropriation of \$250,000.00 from the American Rescue Plan Act (ARPA) funds for the purchase, construction and installation of four additional bus shelters along the Post Road. The work will be bid out utilizing the Towns typical purchasing procedures. The current appropriation for the four (4) bus shelters is considerably more than the 2021 appropriation due to the significant increase in material cost for the shelters themselves. Mr. Ratkiewich showed maps of the Post Road where the bus stops approved by the RTM in 2021 were currently being installed and where he anticipated the new stops would be located. Mr. Ratkiewich also explained that as part of the current Post Road upgrade construction project undertaken by the CT DOT an additional four (4) bus shelters would be installed. The committees asked several general questions and voted as follows; The Public Works Committee voted 6-0 to recommend, the Finance Committee voted 7-0 to recommend and the Transit Committee voted 5-0 to recommend approval to the full RTM.

Pump Station Force Main Repairs - Mr. Ratkiewich requested an appropriation of \$275,000.00 from the Sewer Reserve Fund for the third round of emergency repairs to the Pump Station #10 force main. This work has already been completed. Mr. Ratkiewich showed a map of the area as well as a cross section of the force main. Pump Station #10 is located on Greens Farm Road at the Town Line and runs westerly along Greens Farm Road, up Bulkley and across the Stop & Shop Parking lot then all the way up to Maple Avenue where it discharges into a gravity line. Mr. Ratkiewich then explained the sequence of the repairs; The first 1,000-foot repair to this line occurred in 2022, the second repair which was appropriated in August of this year was to be for the area requested in this appropriation however due to some unforeseen bends in the existing pipe directly below an electric duct bank, the subsequent 1,000 linear feet scheduled as the next repair was completed while the pipe bends were investigated. In November the last of the repairs was completed, including the areas of the pipe bends. All three of these repair projects are part of a larger project to replace the entire force main which is in the 5-year capital forecast at \$750,000. The committees asked several general questions and voted as follows; The Public Works Committee voted 6-0 to recommend and the Finance Committee voted 7-0 to recommend approval to the full RTM.

In attendance;

PW Comm (6) - Jay Keenan (chair/reporter), Don O'Day (Fin), Ari Benmosche (Fin/Transit), Dick Lowenstein (Chair Transit), Chris Tait, Andrew Colabella

Finance Comm (7) – Seth Braunstein (chair), Lyn Hogan, Rachel Cohn (Transit), Nancy Kail, David Rosenwaks
Transit Committee (5) – Andrew Bloom, Sal Liccione

Sec. 1. - Schedule of fees.

| § | Description | Fee Amount |
|----------------------------------|---|------------|
| <i>Chapter 2. Administration</i> | | |
| 2-55 | Land use fees. | |
| | B. Zoning permits. | |
| | The fee for a zoning permit for new construction and/or alterations shall be based upon the estimated cost of the project at a rate of: | |
| | (1) For residential: | |
| | Minimum residential permit fee: | \$40.00 |
| | \$2.00 per \$1,000.00, or part thereof, of construction cost up to \$100,000.00. | |
| | \$3.00 per \$1,000.00, or part thereof, construction cost from \$100,001.00 up to \$499,999.00. | |
| | \$4.00 per \$1,000.00, or part thereof, construction cost over \$500,000.00. | |
| | (2) Special permit uses in residential zones: | |
| | Minimum special permit fee: | \$50.00 |
| | \$3.00 per \$1,000.00, or part thereof, of construction cost up to \$100,000. | |

4861-9794-3447, v. 1

| | | | |
|--|--|--|---------|
| | | \$4.00 per \$1,000.00, or part thereof, of construction cost from \$100,001.00 up to \$499,999.00. | |
| | | \$5.00 per \$1,000.00, or part thereof, of construction cost from \$500,000.00 up to \$999,999.00. | |
| | | \$6.00 per \$1,000.00 or part thereof construction cost over \$1,000,000.00. | |
| | | | |
| | (3) Commercial and multifamily in all zones: | | |
| | | Minimum commercial permit fee: | \$75.00 |
| | | \$5.00 per \$1,000.00, or part thereof, of construction cost up to \$100,000.00. | |
| | | \$7.00 per \$1,000.00, or part thereof, of construction cost from \$100,001.00 up to \$499,999.00. | |
| | | \$8.00 per \$1,000.00, or part thereof, of construction cost from \$500,000.00 up to \$999,999.00. | |
| | | \$9.00 per \$1,000.00, or part thereof, of construction cost over \$1,000,000.00. | |
| | | | |
| | (4) (a) Freestanding sign permit and zoning certificate of compliance. | | \$80.00 |
| | (b) Freestanding portable sign. | | \$40.00 |

4861-9794-3447, v. 1

| | | | |
|--|--|--|--|
| | | | |
| | | (5) Wall sign permit and zoning certificate of compliance. | \$80.00 |
| | | | |
| | | (6) Conditional zoning certificate of compliance: | |
| | | (a) Residential. | \$40.00 |
| | | (b) Commercial and special permit uses. | \$75.00 |
| | | | |
| | | (7) Final zoning certificate of compliance: | |
| | | (a) Residential. | \$40.00 |
| | | (b) New residential house. | \$75.00 |
| | | (c) Commercial/multifamily/special permit uses. | \$150.00 |
| | | (d) Each additional inspection will require the inspection zoning certificate of compliance fee to be charged again as listed above. | |
| | | | |
| | | (8) Zoning permit renewals. | All applications for the renewal of a zoning permit shall be accompanied by a fee of ten percent of the original application fee. |
| | | | |
| | | (9) Inclusionary zoning fee. | All applications for a zoning permit shall be accompanied by a fee to be used for constructing, rehabilitating, or repairing housing affordable to persons and families of low and moderate income pursuant to C.G.S. § 8-2i: \$5.00 per \$1,000 of construction cost |

4861-9794-3447, v. 1

[Authority: "Westport Affordable Housing Trust Fund" (WAHTF) Town Ordinance approved by RTM 10/3/23;
Section 45-3.6.3. of the Town Zoning Regulations approved by P&Z Commission 12/18/23]

(10) Zoning permits for approvals sought "after the fact" or for the correction of a violation shall pay double the fee listed above.

(11) When a permit is revoked due to a violation, the zoning permit fee shall be paid again before the permit can be reissued.

(Resolution of _____, effective 14 days after publication on _____)

§ 8-2i. Inclusionary zoning, CT ST § 8-2i

Connecticut General Statutes Annotated
Title 8. Zoning, Planning, Housing and Economic and Community Development (Refs & Annos)
Chapter 124. Zoning (Refs & Annos)

C.G.S.A. § 8-2i

§ 8-2i. Inclusionary zoning

Currentness

(a) As used in this section, “inclusionary zoning” means any zoning regulation, requirement or condition of development imposed by ordinance, regulation or pursuant to any special permit, special exception or subdivision plan which promotes the development of housing affordable to persons and families of low and moderate income, including, but not limited to, (1) the setting aside of a reasonable number of housing units for long-term retention as affordable housing through deed restrictions or other means; (2) the use of density bonuses; or (3) in lieu of or in addition to such other requirements or conditions, the making of payments into a housing trust fund to be used for constructing, rehabilitating or repairing housing affordable to persons and families of low and moderate income.

(b) Notwithstanding the provisions of any special act, any municipality having zoning authority pursuant to this chapter or any special act or having planning authority pursuant to chapter 126¹ may, by regulation of the body exercising such zoning authority, implement inclusionary zoning regulations, requirements or conditions.

Credits
(1991, P.A. 91-204.)

Footnotes

¹ C.G.S.A. § 8-18 et seq.

C. G. S. A. § 8-2i, CT ST § 8-2i
The statutes and Constitution are current with all enactments of the 2023 Regular Session and the 2023 September Special Session.

The Westport Affordable Housing Trust Fund (WAHTF)

Section 1: Purpose of Fund

The purpose of the Fund shall be to accumulate and administer funds to be used for the preservation of existing and the creation of new affordable rental and home ownership housing in the Town. The preservation and creation of affordable housing shall include but not be limited to programs designed to further housing rehabilitation and/or development opportunities and to provide for a full range of housing choices throughout the Town.

Section 2: Establishment of Affordable Housing Committee; members; terms; annual report.

The First Selectman shall appoint an Affordable Housing Committee (the "AHC"), subject to confirmation by the Representative Town Meeting ("RTM"), consisting of five members who are electors of the Town to serve terms of four years; provided, however, that the initial appointees shall have staggered terms so that three members shall serve for two years and the remaining members shall serve for four years. No more than three members of the Committee shall be members of the same political party.

Section 3: Powers and duties of Committee.

A. The AHC shall:

- (1) Study the need for affordable housing within the Town;
- (2) Make an inventory of sites within the Town which may be suitable for affordable housing;
- (3) Track the availability of such sites; and
- (4) Study sources of funding for affordable housing.

B. The AHC may:

- (1) Consult such other Town bodies and hold such public hearings as it deems necessary to assist it in conducting its studies and making its recommendations;
- (2) Advise the First Selectman and Selectman's Real Property Committee of site acquisition opportunities; and
- (3) Make recommendations to the Board of Selectmen, Board of Finance and RTM, if appropriate, regarding the acquisition, creation, or preservation of affordable housing, including the use of both Town and other funding sources.

Section 4: Establishment of Westport Affordable Housing Trust Fund:

Pursuant to C.G.S. § 7-148(c)(2)(K), the Town does hereby create a special fund to provide affordable housing for the Town of Westport. The fund shall be known as the "Westport Affordable Housing Trust Fund" (the "Fund"). The Fund shall not lapse at the end of the municipal fiscal year.

Section 5: Sources of funding; investments; limitations on use of fund.

- A. In addition to such sums as may be directly appropriated by the Town for deposit into the Fund (if any), the Town is authorized to deposit some or all other monies received by it into the Fund for the purposes of affordable housing, from whatever source such monies are received. The sources may include, but are not limited to, Planning & Zoning fees, Building Department fees, inclusionary zoning fees, monetary gifts, grants, loans, and monies received from local, state and federal agencies. The sources shall not include the existing Real Property Fund established by the Town.
- B. Said fund shall be in the custody of the Town. All or any part of the monies in the Fund may be invested in any securities in which public funds may be lawfully invested. All income derived from such investment shall be placed into the fund and become a part thereof. The monies so invested shall at all times be subject to withdrawal for use as hereinafter set forth.
- C. No sums contained in the Fund, including interest and dividends earned, shall be transferred to any other account within the Town budget. However, in the event that work is performed by departments of the Town pursuant to this chapter, the cost of said work may be reimbursed from the fund.. No expenditure shall be made from the Fund except in accordance with the provisions of this chapter. No expenditure shall be made from the Fund in excess of the available balance in the Fund.

Section 6: Expenditures from the Fund.

- A. The continuation of the Fund shall be perpetual, notwithstanding that from time to time the Fund may be unfunded.
- B. Expenditures shall be used exclusively for affordable housing, as that term is defined in Title 8 of the Connecticut General Statutes and/or the Town's Zoning Regulations, as follows:
 - a. Costs associated with the investigation, appraisal, acquisition, administration and maintenance of parcels of land, both improved and unimproved, or development rights, easements, deed restrictions, options, interests or rights therein;
 - b. Development, rehabilitation, repair and construction of affordable housing ; and/or
 - c. Acquisition of buildings, structures or parts thereof.
- 2. Recommendations for any and all proposed expenditures from the Fund shall be submitted to the AHC and the Board of Finance and the RTM for approval. Recommendations from AHC and Board of Finance and the RTM for expenditures from the Fund shall be submitted, including the sum to be expended, to the Board of Selectmen for approval.
- 3. The AHC will provide an annual report of the amount in the Fund and the expenditures to members of the RTM at its January meeting.