

EXISTING DETAIL PLAN VIEW

SCALE: 1" = 30'
 30' 0' 30'

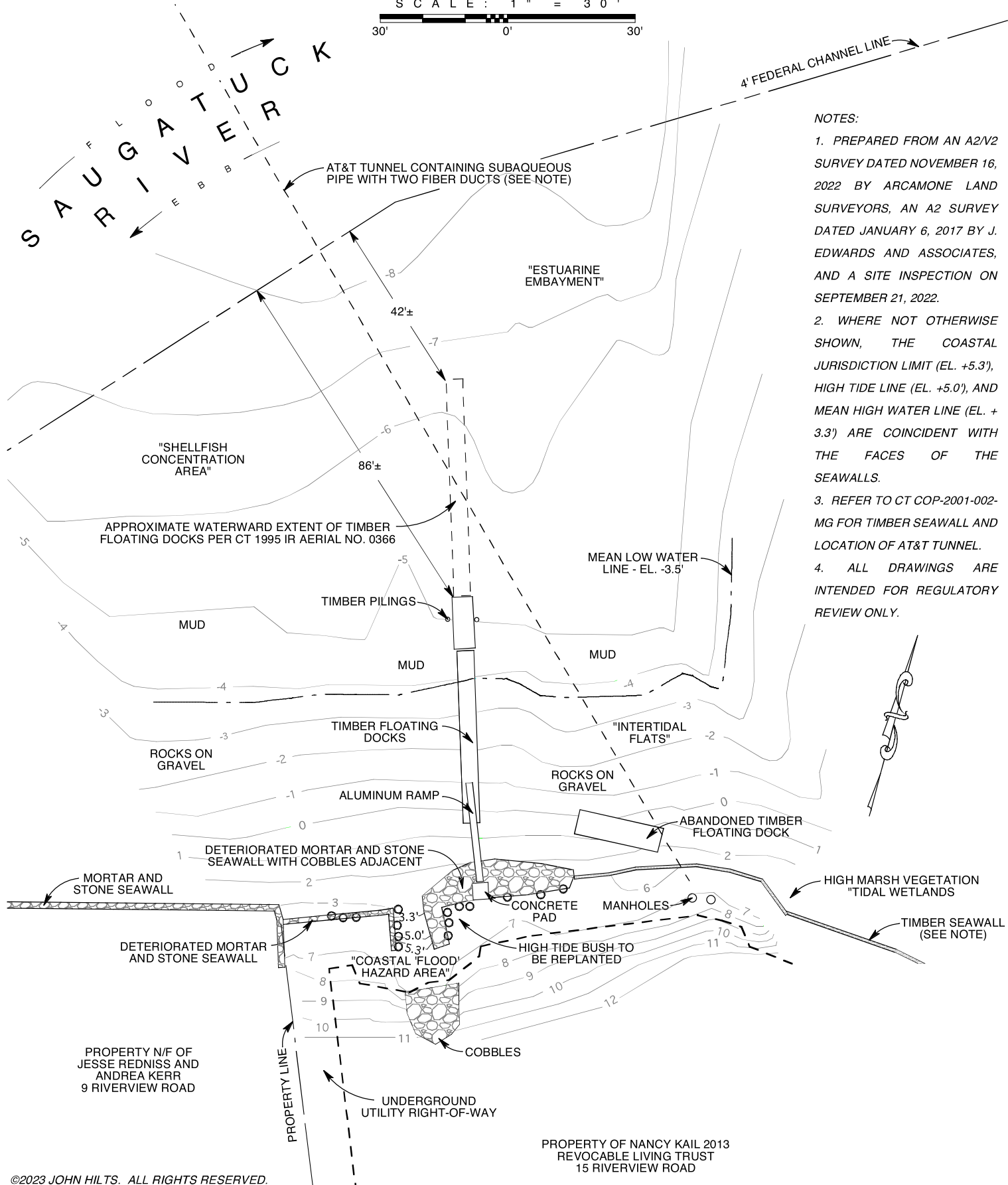

- NOTES:
1. PREPARED FROM AN A2/V2 SURVEY DATED NOVEMBER 16, 2022 BY ARCAMONE LAND SURVEYORS, AN A2 SURVEY DATED JANUARY 6, 2017 BY J. EDWARDS AND ASSOCIATES, AND A SITE INSPECTION ON SEPTEMBER 21, 2022.
 2. WHERE NOT OTHERWISE SHOWN, THE COASTAL JURISDICTION LIMIT (EL. +5.3'), HIGH TIDE LINE (EL. +5.0'), AND MEAN HIGH WATER LINE (EL. +3.3') ARE COINCIDENT WITH THE FACES OF THE SEAWALLS.
 3. REFER TO CT COP-2001-002-MG FOR TIMBER SEAWALL AND LOCATION OF AT&T TUNNEL.
 4. ALL DRAWINGS ARE INTENDED FOR REGULATORY REVIEW ONLY.

©2023 JOHN HILTS. ALL RIGHTS RESERVED.

<p>PURPOSE: EROSION CONTROL AND PRIVATE RECREATIONAL BOAT DOCKING DATUM: NORTH AMERICAN VERTICAL DATUM OF 1988 ADJACENT OWNERS: JESSE REDNISS AND ANDREA KERR; JOYCE MIRIZIO APPLICATION PREPARED BY: JOHN HILTS P.O. BOX 47, ROWAYTON, CT 06853</p>	<p>PROPOSED SEAWALL REPAIRS AND PIER, RAMP AND FLOATING DOCK IN THE SAUGATUCK RIVER AT 15 RIVERVIEW ROAD, WESTPORT, FAIRFIELD COUNTY, CT APPLICANT: NANCY KAIL 2013 REVOCABLE LIVING TR. DATE: 7/11/23 SHEET 3 OF 7 REVISION NUMBER: 1 DATE: 8/07/23</p>
---	--