



WESTPORT

TOWN OF WESTPORT
CONSERVATION DEPARTMENT

TOWN HALL – 110 MYRTLE AVENUE
WESTPORT, CT 06880
P 203.341.1170 F 203.341.1088

June 26, 2023

Mary Jaehnig
c/o Pfizer-Jaehnig Soils, LLC
17 Fairview Avenue
Ridgefield, CT 06877

Re: Request for Wetland Boundary Map Verification
Application #IWW/M-11762-23
52 Marion Road, Westport, CT

Dear Ms. Jaehnig:

An application has been submitted to the Westport Conservation Commission which proposes to amend the wetland boundary on the property located at 52 Marion Rd. This letter is written to request your services to review the material submitted and to conduct a site inspection verifying the proposed boundary and soil classification.

Enclosed for your use is the application, a copy of the Town's GIS map showing the existing wetland boundary, and the survey map dated November 10, 2021, revised to May 16, 2023 showing the location of the flagged wetland delineation. The wetland boundary was flagged by Chris Allan & Anthony Zemba, Professional Soil Scientist.

Our meeting for the map amendment application is scheduled for July 19, 2023. A report from you received by July 10, 2023 would be greatly appreciated.

Thank you and please contact this office should you have any questions.

Sincerely,

Colin Kelly
Conservation Director

Enclosures

File: Wetland Maps SS verification 52 Marion



Westport, CT



June 26, 2023

1 inch = 60 Feet

www.cai-tech.com

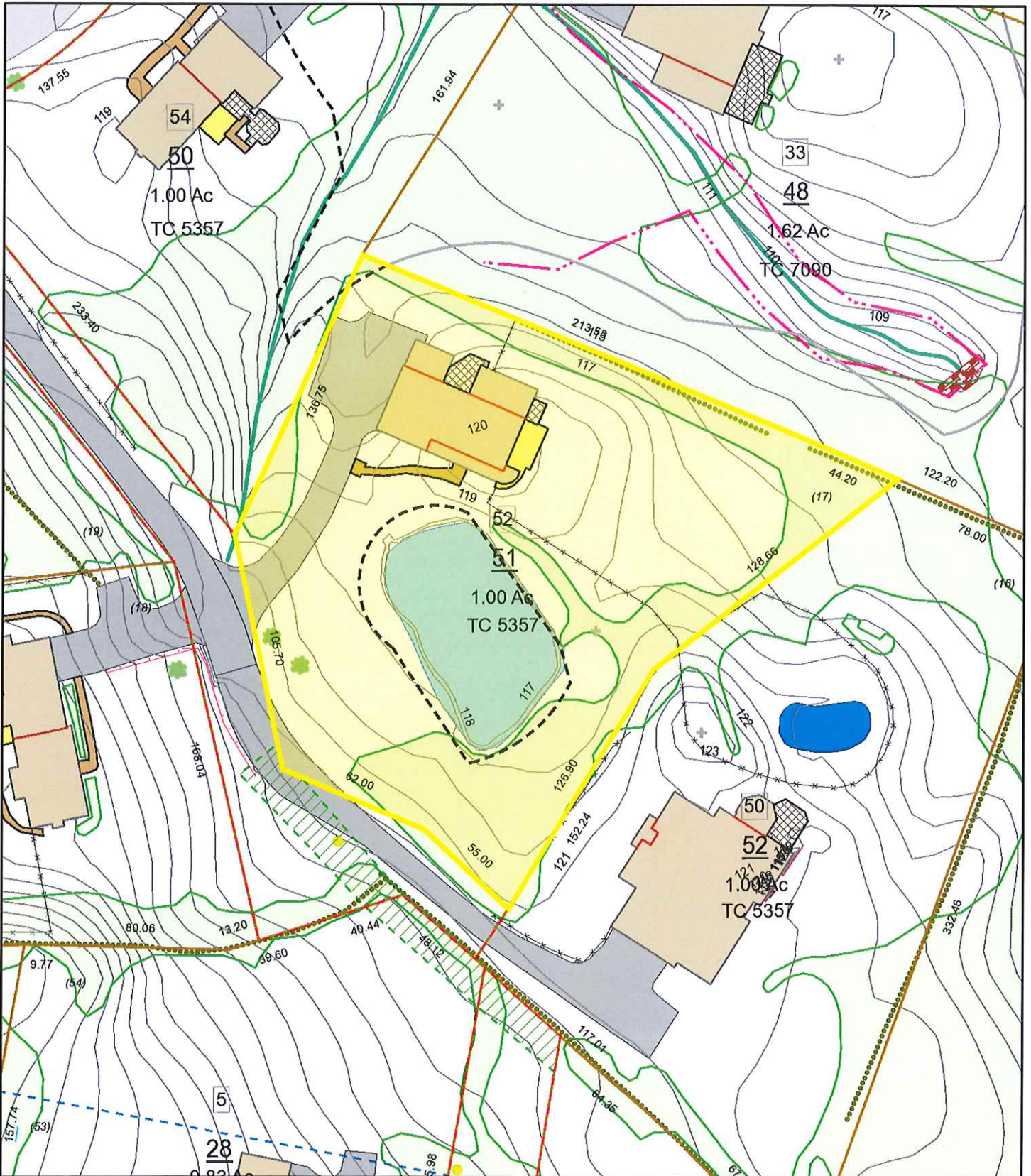

Data shown on this map is provided for planning and informational purposes only. The municipality and CAI Technologies are not responsible for any use for other purposes or misuse or misrepresentation of this map.