

6. New Business
7. Old Business

- a. **263 Riverside Avenue:** Review and comment on revised dock plans for resubmission to CT DEEP.

Catherine Calise presented the application on behalf of the property owner.

Ms. Mozian reminded the Commission of what was previously reviewed and the comments given. The previous plan was for a 60-foot extension into the Saugatuck River and the float was 90 feet long.

Ms. Calise stated the revised plan proposes a gangway is 30 feet long connected to a 5-foot by 40-foot long dock so it will not encroach into the river nearly as far. Mushroom anchors will hold the dock in place. Air Pillars will act as float stops. The mushroom anchors will eliminate the need for pilings. If pilings are needed, then they will still be hand driven. The dock will be pre-made and brought in by truck. This is a private dock for public transient use.

Motion to support the plan amendment dated March 31, 2021 for the proposed dock. A finding of not a significant impact to the natural beds was made.

Motion:	Higgins	Second:	Walsh
Ayes:	Higgins, Walsh, Williams, Harris		
Nays:	None	Abstentions:	None
		Vote:	4:0:0

8. Other Business

- a. Canal Beach and Hendrick's Point clean-up

Ms. Higgins did the Canal Beach clean-up. She reported she collected approximately ¾ of a bag of garbage.

The Hendrick's Point clean-up is taking place on May 6, 2021 at 4:00 p.m. with Ms. Williams, Mr. Walsh and Mr. Harris participating.

Ms. Williams noted that the "No Shellfishing" sign needs to be replaced.

Ms. Mozian will look into getting the sign and Mr. Walsh will take on installing the sign.

Commission members noted that a "No Littering" sign should be installed in the area.

The May 5, 2021 meeting of the Westport Shellfish Commission adjourned at 7:30 p.m.

Motion:	Williams	Second:	Walsh
Ayes:	Williams, Walsh, Harris, Higgins		
Nays:	None	Abstentions:	None
		Vote:	4:0:0

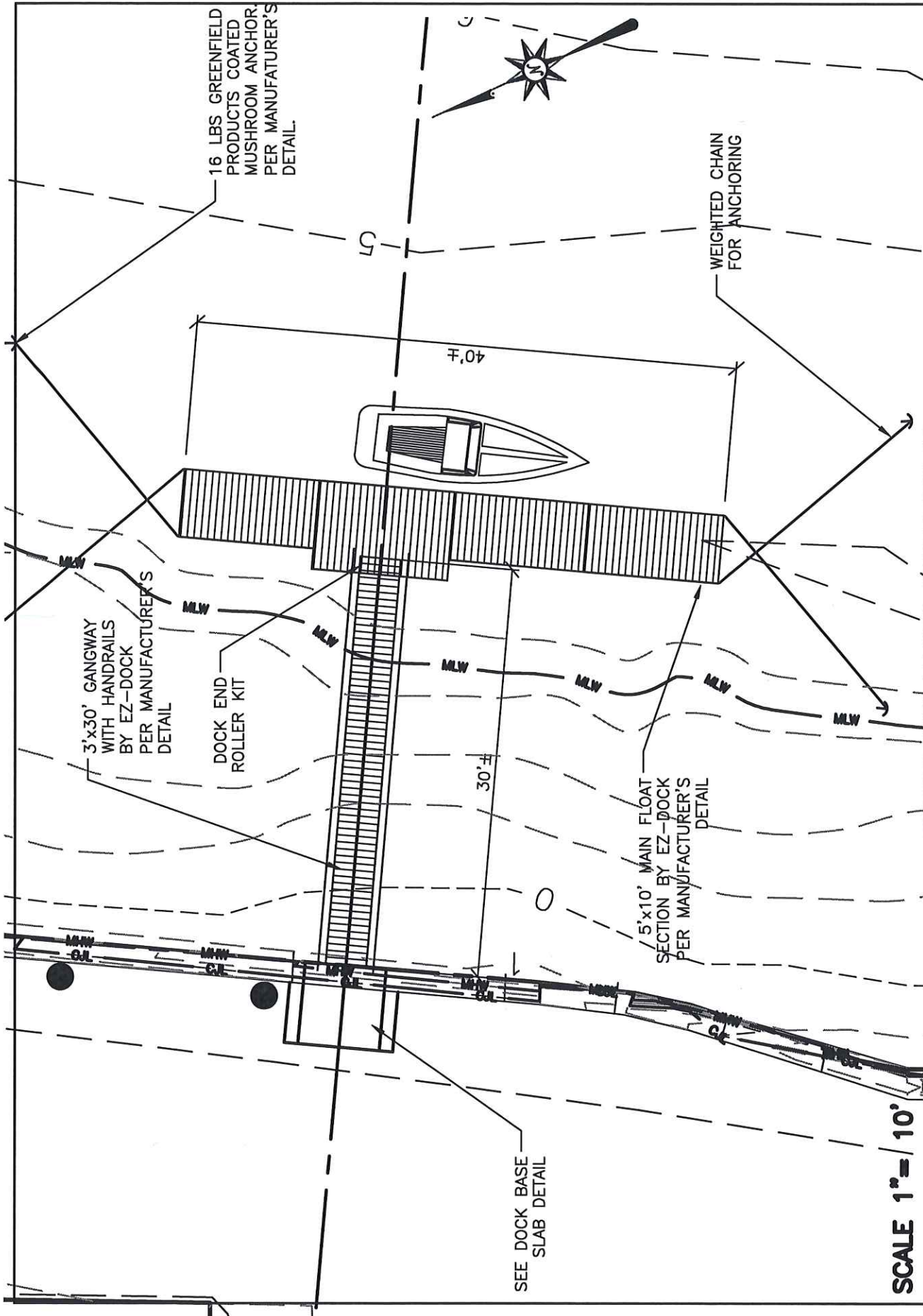

16 LBS GREENFIELD PRODUCTS COATED MUSHROOM ANCHOR, PER MANUFACTURER'S DETAIL.

5

40'±

30'±

WEIGHTED CHAIN FOR ANCHORING

3'x30' GANGWAY WITH HANDRAILS BY EZ-DOCK PER MANUFACTURER'S DETAIL

DOCK END ROLLER KIT

5'x10' MAIN FLOAT SECTION BY EZ-DOCK PER MANUFACTURER'S DETAIL

SEE DOCK BASE SLAB DETAIL

SCALE 1" = 10'



J. EDWARDS & ASSOCIATES, LLC
 Engineering and Surveying
 227 Stepney Road
 Easton, CT, 06612
 (203) 268-4205
 www.leassoc.com

PROPOSED DOCK LOCATION, CONFIGURATION AND DETAILS BASED ON INFORMATION PROVIDED BY OTHERS. SEE DETAILS FROM EZ-DOCK MANUFACTURER (FWM) FOR ALL INSTALLATION SPECIFICATIONS. FWM - EZ DOCK POINT OF CONTACT: KEITH WILSON 11 FRIARS DRIVE - HUDSON, NH 03051 603.417.5661

PROPOSED DOCK PLAN
 263 RIVERSIDE AVENUE
 WESTPORT, CONNECTICUT
 SCALE 1" = AS NOTED
 MARCH 31, 2021

PROFILE

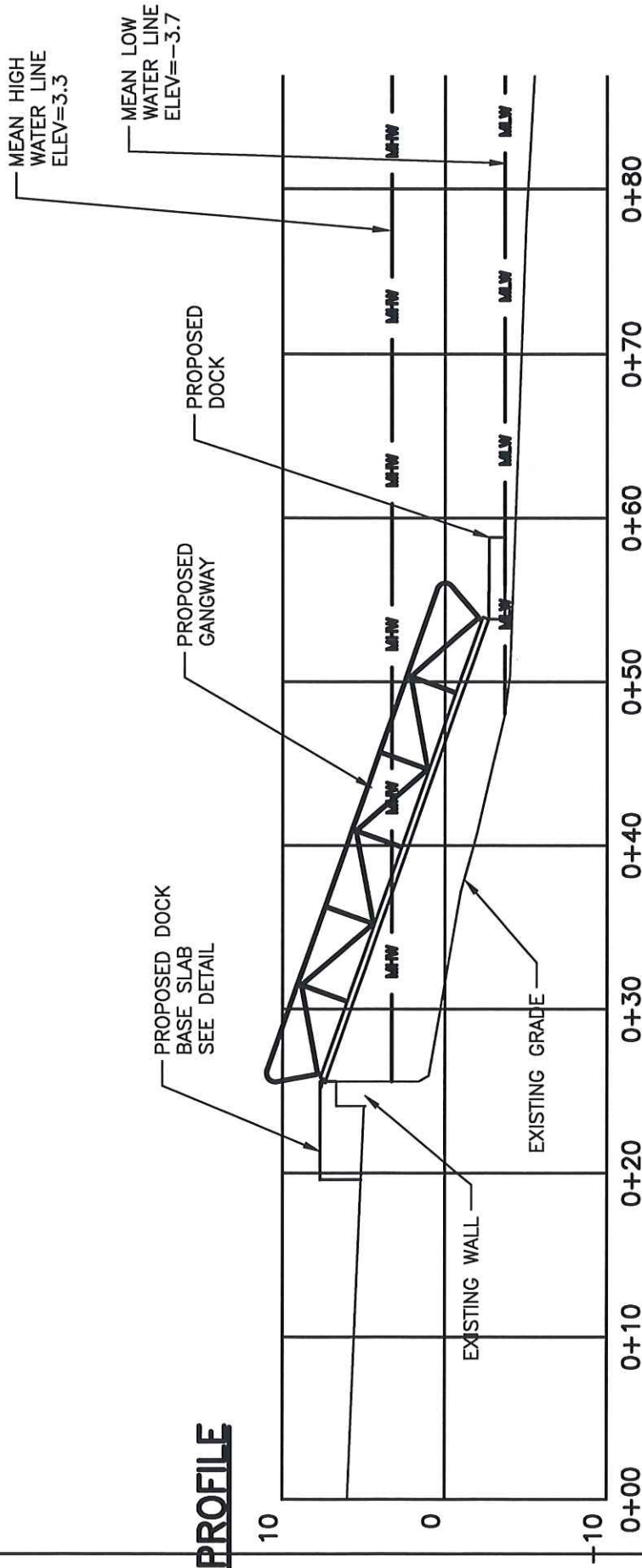

SCALE 1" = 10'

PROPOSED DOCK LOCATION, CONFIGURATION AND DETAILS BASED ON INFORMATION PROVIDED BY OTHERS. SEE DETAILS FROM EZ-DOCK MANUFACTURER (FWM) FOR ALL INSTALLATION SPECIFICATIONS.

FWM - EZ DOCK POINT OF CONTACT:
KEITH WILSON
11 FRIARS DRIVE - HUDSON, NH 03051
603.417.5661



J. EDWARDS & ASSOCIATES, LLC
Engineering and Surveying
227 Stepney Road
Easton, CT. 06612
(203) 268-4205
www.leassoc.com

PROPOSED DOCK PLAN
263 RIVERSIDE AVENUE
WESTPORT, CONNECTICUT
SCALE 1" = AS NOTED
MARCH 31, 2021

NOTES:

1. REFERENCE MAP ENTITLED: "EXISTING CONDITIONS SURVEY, 263 RIVERSIDE AVENUE, WESTPORT, CONNECTICUT." SCALE 1"=20'. DATED FEBRUARY 05, 2021. PREPARED BY J. EDWARDS & ASSOCIATES, LLC.
 2. PLAN PREPARED FOR RIVERSIDE AVENUE HOLDINGS LLC.
 3. LOCATION OF UNDERGROUND UTILITIES DEPICTED HEREON ARE APPROXIMATE.
 4. CERTIFICATION OF THIS PLAN DOES NOT APPLY TO STRUCTURAL ELEMENTS ASSOCIATED WITH THE DOCK COMPONENTS. PRIOR TO INSTALLATION PLANS SHOULD BE REVIEWED BY EZ-DOCK STRUCTURAL ENGINEER TO VERIFY DOCK MOUNTING PLATFORM IS SUITABLE FOR ANTICIPATED LOADS.
 5. EXISTING TOPOGRAPHIC FEATURES BASED ON THE MAP REFERENCED IN NOTE 1 ABOVE.
 6. PROPOSED DOCK LOCATION, CONFIGURATION AND DETAILS BASED ON INFORMATION PROVIDED BY OTHERS. SEE DETAILS FROM EZ-DOCK MANUFACTURER (FWM) FOR ALL INSTALLATION SPECIFICATIONS.
- FWM - EZ DOCK POINT OF CONTACT:**
 KEITH WILSON
 11 FRAMES DRIVE - HUDSON, NH 03051
 603.417.5661
7. OWNER OR INSTALLER IS RESPONSIBLE FOR OBTAINING ALL NECESSARY PERMITS PRIOR TO INSTALLATION. THIS PLAN PROVIDES NO CERTIFICATION OF COMPLIANCE WITH LOCAL OR FEDERAL REGULATIONS.

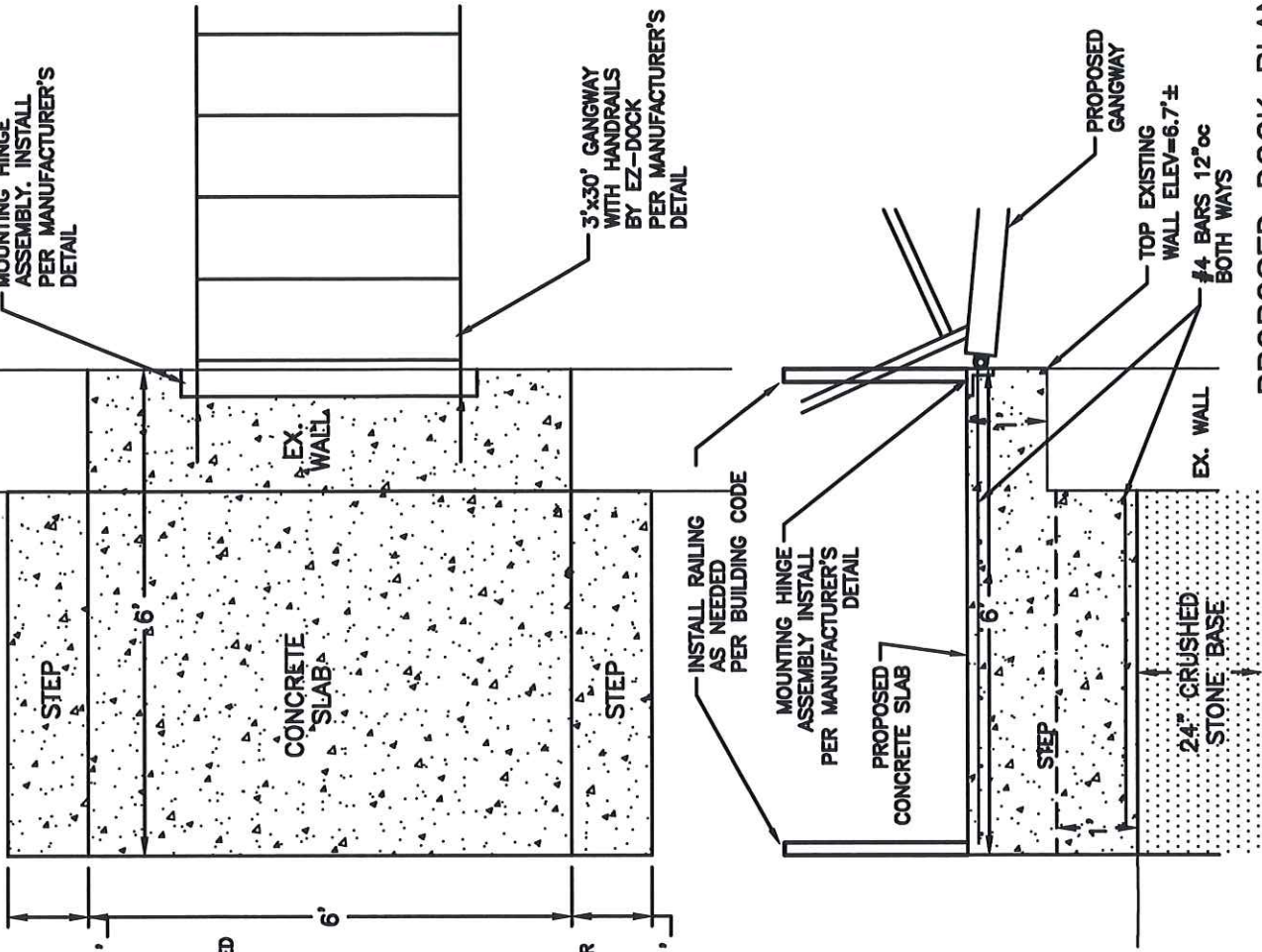

J. EDWARDS & ASSOCIATES, LLC
 Engineering and Surveying
 227 Stepney Road
 Easton, CT, 06612
 (203) 268-4205
 www.leassoc.com

DOCK BASE SLAB DETAIL (NTS) 263 RIVERSIDE AVENUE
 WESTPORT, CONNECTICUT
 SCALE 1"= AS NOTED
 MARCH 31, 2021

PROPOSED DOCK PLAN

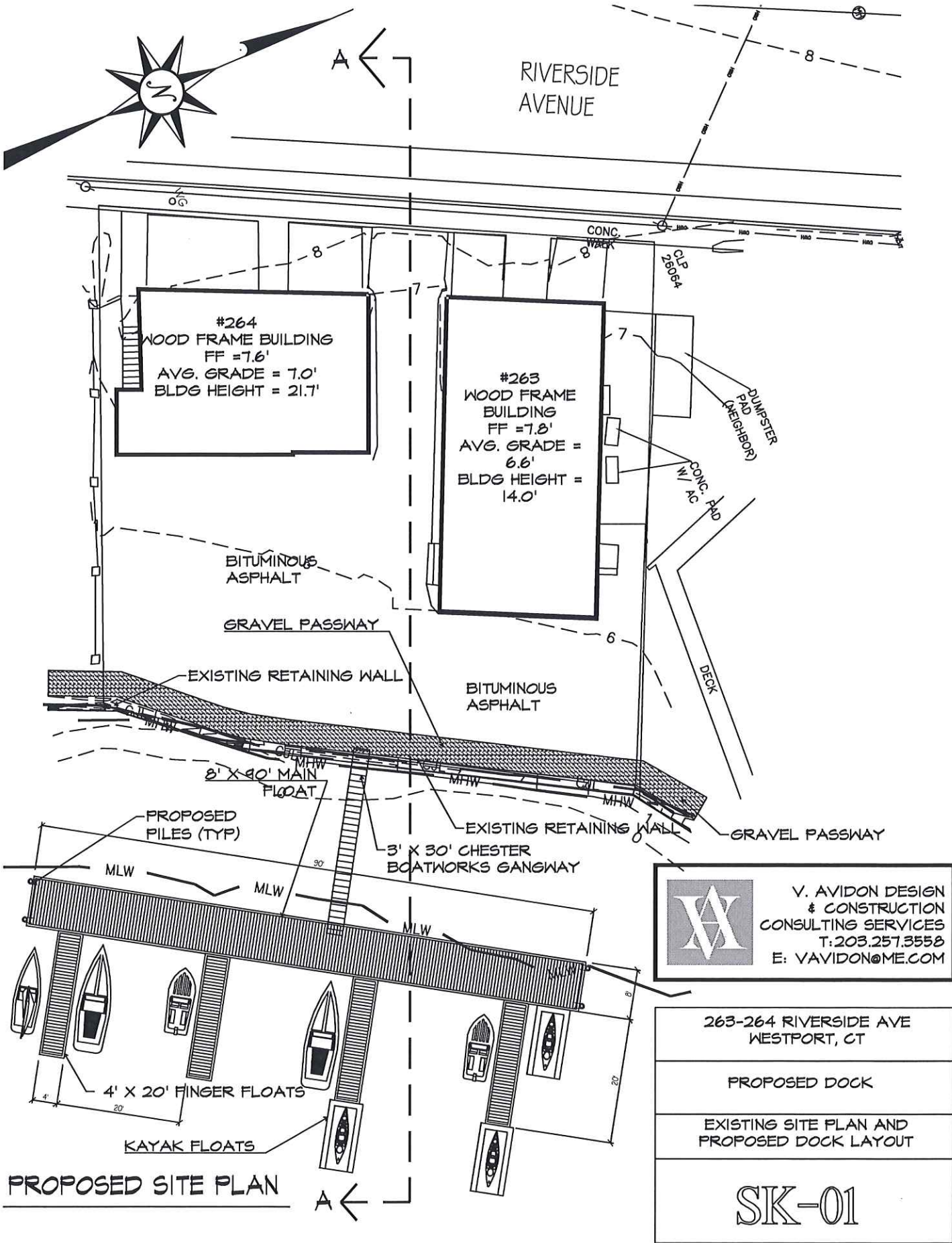

	V. AVIDON DESIGN & CONSTRUCTION CONSULTING SERVICES T: 203.257.3558 E: VAVIDON@ME.COM
	263-264 RIVERSIDE AVE WESTPORT, CT
	PROPOSED DOCK
	EXISTING SITE PLAN AND PROPOSED DOCK LAYOUT

263-264 RIVERSIDE AVE
WESTPORT, CT

PROPOSED DOCK

EXISTING SITE PLAN AND
PROPOSED DOCK LAYOUT

SK-01